

i3SYNC Touch Transmitter

User manual

Product Appearance

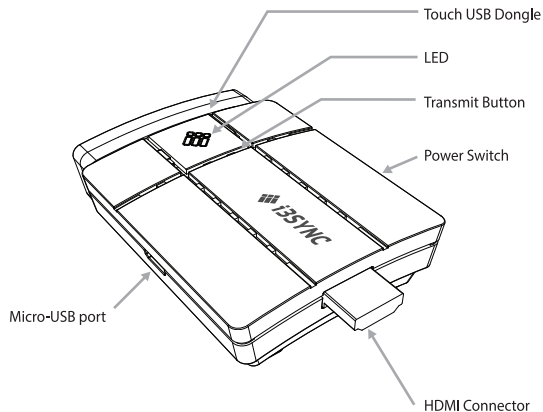

Features

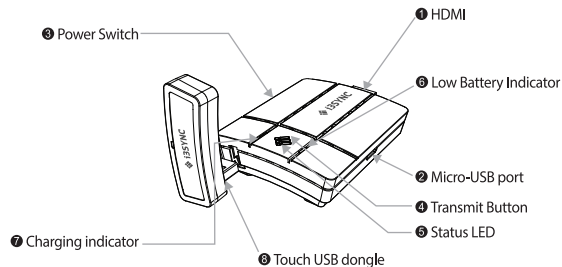

- ① HDMI connector : Connect to HDMI OUT port of laptop or PC
- ② Micro-USB port : Charge transmitter using USB cable
- ③ Power switch : Power ON/OFF
- ④ Transmit button : Start transmission (and click to end transmission)
Switch to this transmission (when using multiple transmitter).
- ⑤ Status LED (device connected)
 - Purple : System booting
 - Blue : Ready to stream
 - Blue (blinking) : Video streaming
 - Red : HDMI pairing error
- ⑥ Low Battery LED
 - Orange : Low battery
- ⑦ Charging LED
 - Red : Currently charging
- ⑧ Touch USB Dongle : Connect to USB port of laptop or PC where Transmitter is connected

Installation

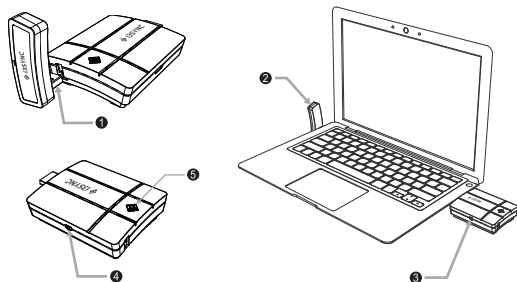

- ① Remove the Touch USB Dongle from the Transmitter.
 - ② Insert the Dongle into the USB In port of your laptop or PC.
 - ③ Connect the Transmitter to the HDMI out port of laptop or PC.
Use the HDMI extension cable provided if needed.
 - ④ Slide the power switch to the left to turn power ON and the Status LED will be lit in blue.
 - ⑤ Press the Transmit button and an image will appear on the display device of which the Receiver is installed.
- If multiple Transmitters are connected, the corresponding screen of the Transmitter that has just been clicked will appear, as part of the product's integrated switching function.

For first use : please find the instructions to pair transmitter with receiver in the User Manual of the Receiver, or on www.i3-learning.com

Recharging

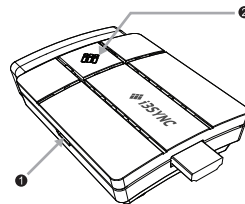

- Please charge Transmitter when you see orange light on status LED or when power does not turn on.

- ① Use provided USB cable and connects it to USB port of laptop or PC. Or you can use additional adapter (5V/2A) for charging. Transmitter must be turned off while charging.
 - ② Red light will show on Status LED when Transmitter is being charged, and the light will be gone after charging is finished.
- Charging time may vary depending on the current. If you are charging with an adapter of 5V/2A, it takes about 2 hours 30 minutes for full charge when the battery is empty.

Notice

The distance available for wireless application may vary depending on the user environment. The wireless device in use may be subjected to radio interference during operation. The screen in part may not show if the aspect ratio of image being replayed does not match with that of the monitor.

Turn power OFF of the product and of the Transmitter when not in use.