

i3TOUCH V-SENSE

V8404 4K T10 USER MANUAL





CONTENTS

1. Important safety Instructions	3
1.1 Safety precautions	
1.2 Care and maintenance	
2. Introduction	9
3. Parts description	10
3.1 Front View	
3.2 Rear View	
4. Remote control	12
5. OSD menu	14
6. Troubleshooting	36
7. Touch configuration	37
7.1 Driver download	
7.2 Connecting the touch sensor	
7.3 Installing the drivers	
7.4 What to check when drivers can't be installed	
7.5 Power supply	
7.6 USB-cabling of the i3TOUCH	
7.7 Connecting the display (VGA/HDMI/DVI/DP)	
7.8 Calibrating the I3TOUCH	
7.9 What to do if calibration is still inaccurate even after calibrating in V-sense & windows	
7.10 What to do if windows calibration does not start	
7.11 Disabling "USB Selective suspend setting"	
7.12 No touch after installing the driver	
7.13 What to do if you can't duplicate your screen	

1. Important Safety Instructions

Icons used for safety precautions

ICON	NAME	MEANING
	Warning	If precautions marked with this sign are not followed, this may result in a serious injury or even a fatality
	Caution	If precautions marked with this sign are not followed, this may result in a injury or property damage

After unpacking, grab the display with the upper handle and the bottom bezel.

- The display must be kept in a horizontal stable position
- When putting the product on the bottom, make sure the bottom part (speaker bar) will not get damaged. Therefore, preferably use table stands

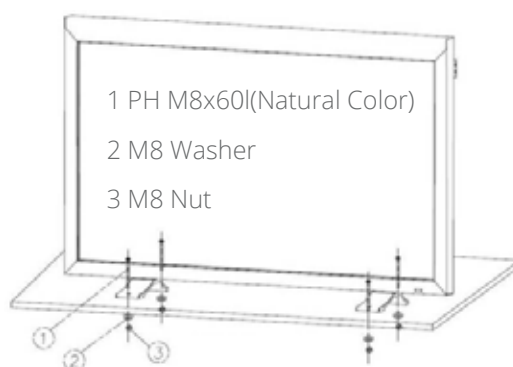
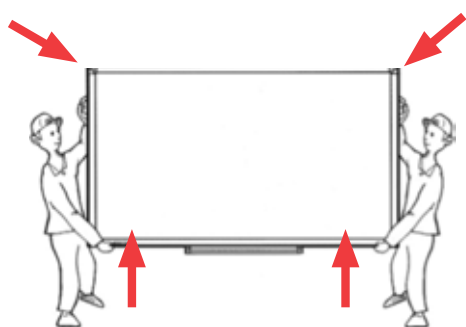

1.1 Safety Precautions

1.1.1 Power Related



Warning

- 1.1.1.1 Avoid using a damaged power cord or plug or a loose power outlet.
 - » Otherwise, it may result in electric shock or fire.
- 1.1.1.2 Avoid connecting multiple electric appliances to a single wall outlet.
 - » Otherwise, it may result in fire due to overheating of the wall outlet.
- 1.1.1.3 Avoid plugging in or unplugging the power supply with wet hands.
 - » Otherwise, it may result in electric shock.
- 1.1.1.4 Plug the power plug in firmly.
 - » Otherwise, it may result in fire.
- 1.1.1.5 Make sure to connect the power cord to a grounded wall outlet(for insulation class 1 equipment only).
 - » Otherwise, it may result in electric shock or injury.
- 1.1.1.6 Avoid bending or twisting the power cord excessively and avoid placing heavy objects on the cord.
 - » Otherwise, it may result in electric shock or fire due to a damaged power cord.
- 1.1.1.7 Keep the power cord and the product away from a heater.
 - » Otherwise, it may result in electric shock or fire.
- 1.1.1.8 If the pins of the power plug or the wall outlet are covered in dust, clean it using a dry cloth.
 - » Otherwise, it may result in fire.



Caution

- 1. 1.1.9 Avoid unplugging the power plug while the product is operating.
 - » Otherwise, it may damage the product due to electric shock.
- 1. 1.1.10 Make sure to use only the power cord supplied by our company. In addition, do not use the power cord of another electric appliance.
 - » Otherwise, it may result in electric shock or fire.
- 1. 1.1.11 When unplugging the power plug from the wall outlet, make sure to hold it by the plug and not by the core.
 - » Otherwise, it may result in electric shock or fire.
- 1. 1.1.12 Connect the power plug to a wall outlet that can be easily reached.
 - » When a problem occurs with the product, you must unplug the power plug to cut the power off completely. You can not cut the power off completely using only the power button on the product.

1.1.2 Installation Related



Warning

- 1. 1.2.1 Avoid placing burning candles, mosquito repellent or cigarettes on the product.
 - » Otherwise, it may result in fire
- 1. 1.2.2 Ask an installation engineer or relevant company to install the product onto the wall
 - » Otherwise, it may result in injury.
- 1. 1.2.3 Avoid installing the product in a badly ventilated location such as inside a bookshelf or closet.
 - » Otherwise, it may result in fire due to internal over-heating..
- 1. 1.2.4 Keep a distance of at least 10cm (3.93 inches) from the wall when installing the product for ventilation.
 - » Otherwise, it may result in fire due to internal over-heating.
- 1. 1.2.5 Keep the plastic bags used to pack the product away from children.
 - » If children place the plastic bags over their heads, they may suffocate.
- 1. 1.2.6 Avoid installing the product in a location that is unstable or exposed to excessive vibration such as on an unstable or slanted shelf.
 - » The product may fall and this may result in damage to the product or injury..
 - » If you use the product in a location exposed to excessive vibrations, it may result in a problem with the product or fire.
- 1. 1.2.7 Avoid installing the product in a location exposed to dust, moisture (sauna), oil, smoke or water (rain drops) and installing it within a vehicle.
 - » This may result in electric shock or fire.
- 1. 1.2.8 Avoid installing the product in a location exposed to direct sunlight and installing the product near a heat source such as a fireplace or heater.
 - » This may shorten the product life cycle or cause fire.
- 1. 1.2.9 Avoid installing the product in such a way that it could fall by children manipulations.
 - » If the display should fall, this may result in serious injuries.
 - » Since the front part is heavier, install the product on a flat and stable surface.
- 1. 1.2.10 » Avoid rainwater entering the display



Caution

1. 1.2.12 Do not let the product drop while moving it.
 - » This may result in a problem with the product or injury.
1. 1.2.13 Do not place the product face down on the floor.
 - » This may damage the panel of the product.
1. 1.2.14 When installing the product on a console or shelf, make sure that the front of the product does not protrude out of the console or shelf.
 - » Otherwise, this may cause the product to fall off and result in a malfunction or injury.
 - » Make sure to use a cabinet or shelf suitable to the size of the product.
1. 1.2.15 When putting the product down, handle it gently.
 - » Otherwise, it may result in a problem with the product or injury.
1. 1.2.16 If the product is installed in a location where the operating conditions vary considerably, a serious quality problem may occur due to the surrounding environment. In this case, install the product only after consulting one of our service engineers about the matter.
 - » Avoid places exposed to microscopic dust, chemicals, too high or low temperature, high humidity, airports or stations where the product is continuously used.

1.1.3 Cleaning Related



Warning

1. 1.3.1 Before cleaning the product, unplug the power cord.
 - » Otherwise, it may result in electric shock or fire.
1. 1.3.2 When cleaning the product, do not spray water directly over the product parts.
 - » Make sure that water does not enter the product.
 - » Otherwise, it may result in fire, electric shock or a problem with the product.



Caution

1. 1.3.3 Avoid spraying cleansing agent directly onto the product.
 - » This may result in discoloration or cracking of the exterior of the product or the panel coming off.
1. 1.3.4 When cleaning the product, disconnect the power cord and clean the product with the supplied cleaning cloth.
 - » Avoid using chemicals such as wax, benzene, alcohol, thinner, mosquito repellent, fragrance, lubrication or cleansing agent when cleaning the product. This may result in the exterior being deformed or the print being removed.
1. 1.3.5 If you can't get the product clean with just a cloth, use a soft, damp cloth with a "monitor-exclusive cleansing agent" and wipe the product with it.
 - » If no monitor-exclusive cleansing agent is available, dilute a cleansing agent with water at a ratio of 1:10 before cleaning the product.
1. 1.3.6 Since the exterior of the product gets easily scratched, be sure to use a cleansing cloth.

1.1.4 Usage Related



Warning

- 1. 1.4.1 Since a high voltage runs through the product, never disassemble, repair or modify the product yourself.
 - » Otherwise, it may result in fire or electric shock.
 - » If the product needs to be fixed, contact a service centre.
- 1. 1.4.2 To move the product, turn the power off and unplug the power cord, and any other wires connected to the product
 - » Otherwise, it may result in electric shock or fire due to the damaged power cord.
- 1. 1.4.3 If the product generates a strange noise, a burning smell, or smoke, unplug the power plug immediately and contact a service centre.
 - » Otherwise, it may result in electric shock or fire,
- 1. 1.4.4 Avoid letting children hang or climb onto the product.
 - » Otherwise, it may result in the product falling and this may result in injury or death.
- 1. 1.4.5 If you drop the product or the case is damaged, turn the power off and unplug the power cord. Contact a service centre.
 - » Otherwise, it may result in fire or electric shock.
- 1. 1.4.6 Avoid placing objects such as toys and cookies on top of the product.
 - » If a child hangs over the product to grab an object, the object or the product may fall and this may result in injury or even death.
- 1. 1.4.7 When thunder or lighting occurs, unplug the power cord.
 - » Otherwise, it may result in electric shock or fire,
- 1. 1.4.8 Avoid dropping an object over the product or cause impact to the product.
 - » Otherwise, it may result in electric shock or fire.
- 1. 1.4.9 Avoid moving the product by pulling the power cord or antenna cable.
 - » Otherwise, it may result in electric shock, fire or a problem with the product due to damage to the cable.
- 1. 1.4.10 When a gas leak occurs, do not touch the product or the power plug and ventilate immediately.
 - » A spark may result in an explosion or fire.
 - » During a thunder or lightning storm, do not touch the power cord.
- 1. 1.4.11 Avoid lifting up or moving the product by holding only the power cord or signal cable.
 - » Otherwise, it may result in electric shock, fire or a problem with the product due to damage to the cable.
- 1. 1.4.12 Avoid using or placing inflammable spray or objects into the product (the vents, ports, etc)
 - » If water or substances enter the product, turn the power off, unplug the power cord and contact a service centre.
 - » Otherwise, it may result in a problem with the product, electric shock or fire.
- 1. 1.4.13 Avoid placing a liquid container such as a vase, flowerpot, beverage, cosmetics or drugs, or a metal object over the product.
 - » If water or substances enter the product, turn the power off, unplug the power cord and contact a service centre.
 - » Otherwise, it may result in a problem with the product, electric shock or fire.



Warning

- 1. 1.4.14 Displaying a still image for a long time may create a persistent image or stain on the screen.
 - » If you do not use the product for a long time, use the power-saving mode or set the screen saver to the moving picture mode.

1. 1.4.15 When not using the product for a long time such as leaving the room, unplug the power cord from the wall outlet.
 - » Otherwise, it may cause dust accumulation and result in fire caused by overheating or short circuit or result in an electric shock.
1. 1.4.16 Set the appropriate resolution and frequency for the product.
 - » Otherwise, it may result in eye strain.
1. 1.4.17 Avoid turning the product upside down or move the product holding only the stand.
 - » This may cause the product to fall, resulting in damage to the product or injury.
1. 1.4.18 Do not place the adaptor on top of another adaptor.
 - » Otherwise, it may result in fire.
1. 1.4.19 Keep power adaptor away from any other heat source.
 - » Otherwise, it may result in fire.
1. 1.4.20 Remove the vinyl cover of the adaptor before using the adaptor.
 - » Otherwise, it may result in fire.
1. 1.4.21 Always keep power adaptor in well-ventilated area.
1. 1.4.22 Be careful that adaptor should not be in contact with water and therefore not be wet.
 - » This may cause a malfunction, electric shock or fire. Do not use adaptor by the waterside or outside particularly when it rains or snows. Be careful that adaptor should not be wet while cleaning floor with water.
1. 1.4.23 Watching the product from too close a distance continuously may damage your eyesight.
1. 1.4.24 Avoid using a humidifier or cooker near the product.
 - » Otherwise, it may result in electric shock or fire.
1. 1.4.25 It is important to give your eyes some rest(5 minutes every hour) when viewing the product screen for long periods of time.
 - » This will alleviate any eye strain.
1. 1.4.26 Since the display panel is hot after using it for a long time, do not touch the product.
1. 1.4.27 Keep the small accessories in a location out of the reach of children.
1. 1.4.28 Take care when adjusting the angle of the product or the height of the stand.
 - » If your hand or finger is caught, you may be injured.
 - » If the product is tilted excessively, the product may fall and this may result in injury.
1. 1.4.29 Avoid placing a heavy object over the product
 - » Otherwise, it may result in a problem with the product or injury.
1. 1.4.30 When using headphones or earphones, do not turn the volume too high.
 - » Having the sound too loud may damage your hearing.
1. 1.4.31 Be careful that children do not place the batteries in their mouth when removed from the remote control. Place the battery in a location that children or infants cannot reach.
 - » If children have the battery in their mouth, consult your doctor immediately.
1. 1.4.32 When replacing the batteries, insert them with right polarity(+, -).
 - » Otherwise, the battery may become damaged or it may cause fire, personal injury or damage due to leakage of the internal liquid.
1. 1.4.33 Use only specified standard batteries. Do not use new and used batteries together.
 - » This may cause a battery to break or leak and may cause fire, injury, or contamination(damage).
1. 1.4.34 The batteries(and rechargeable batteries) are not ordinary refuse and must be returned for recycling purposes. The customer is responsible for returning the used or rechargeable batteries for recycling.

» The customer can return used or rechargeable batteries to a nearby public recycling centre or to a store selling the same type of the battery or rechargeable battery.

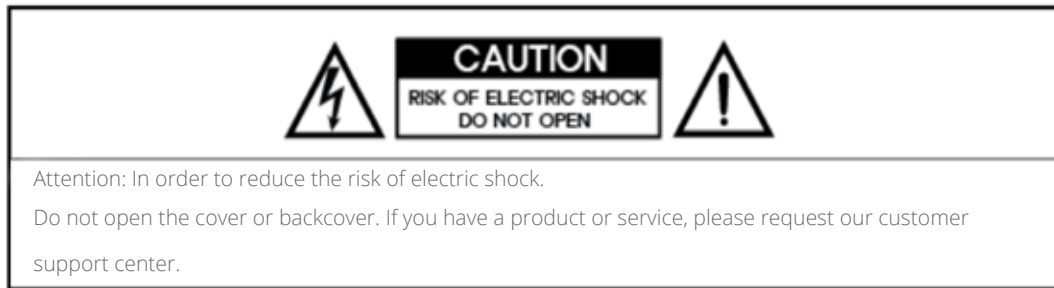

1.2 Care and Maintenance

External Surface and Screen Maintenance

Clean the product with a soft dry cloth.

- Avoid cleaning the product with an inflammable substance such as benzene or thinner or with a wet cloth. This may result in a problem with the product.
- Avoid scratching the screen with your fingernails or a sharp object.
- Avoid cleaning the product by spraying water onto it. If water enters the product, it may result in fire, electric shock or a problem with the product.

A white stain may be generated on the surface of the model if a supersonic humidifier is used near it.

The appearance and the color may differ depending on models.



Securing the Installation Space

- Keep the required distances between the product and other objects (e.g. walls) to ensure proper ventilation. Failing to do so may result in fire or a problem with the product due to an increase in the internal temperature. Install the product so the required distances shown in the figure are kept.

The appearance may differ depending on the product.

When installing the product with a stand

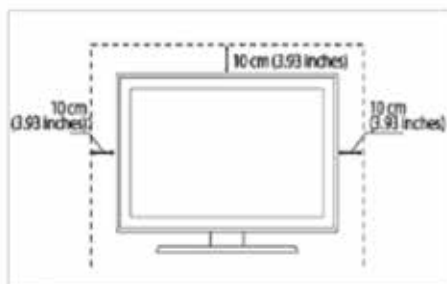

When installing the product with a wall-mount

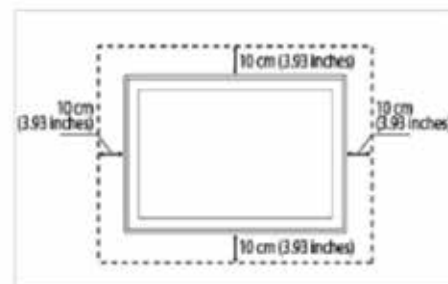

About persistent images

- Displaying a still image for a long time may create a persistent image or stain on the screen. If you do not use the product for a long time, set the power-saving mode or screen saver.
- Due to technological constraints of the Panel manufacturer, pixel errors are sometimes unavoidable. Please consult our pixel policy





2. Introduction

2.1 Package Contents

- Unpack the product and check if all of the following contents has been included.
- Store the packaging box in case you need to move the product later.
- If any items are missing, contact your dealer.
- Contact a local dealer to purchase optional items.





LED Display

Contents	<div></div> <div>User Manual</div>			
Cable	<div></div> <div>HDMI Cable</div>	<div></div> <div>TOUCH Sensor Cable</div>	<div></div> <div>Power Cable</div>	<div></div> <div>RGB cable</div>
Accessory	<div></div> <div>Remote Control</div>	<div></div> <div>Battery(CR-2025 x 1)</div>		<div></div> <div>PEN x 2</div>

3. Parts description

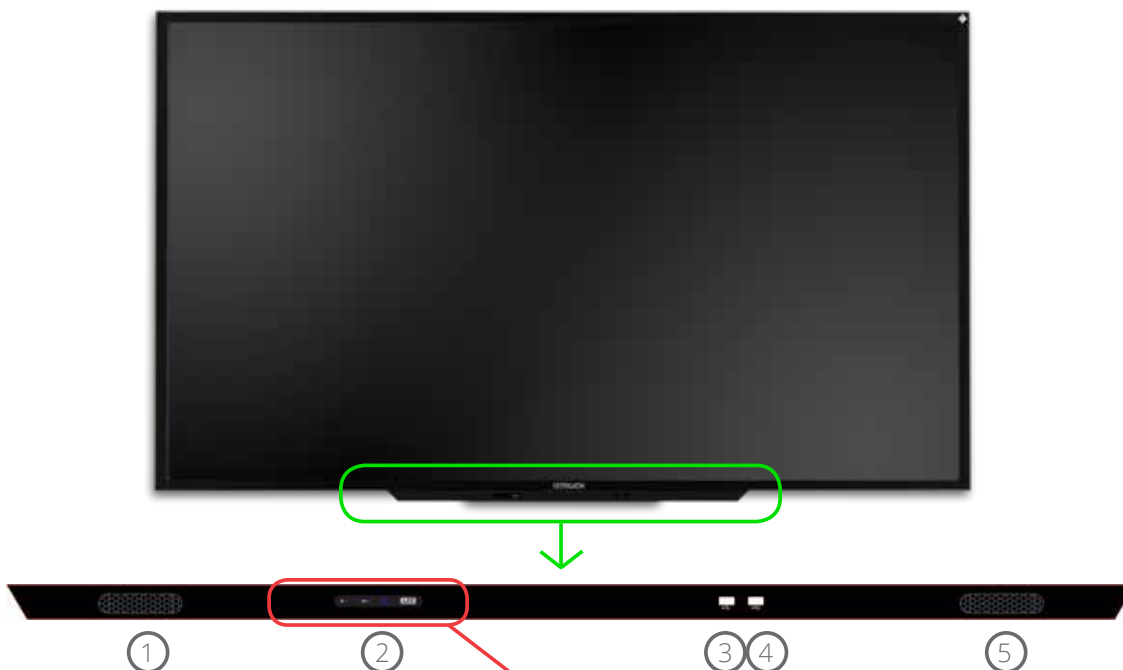
3.1 Front View



- ① ⑤ Speaker
- ② 1. POWER() : Turns the LED Display On/Off.
2. LED Indicator
Shows Power ON mode -- BLUE
Power Saver mode by blinking RED.
Shows Power OFF mode -- RED. .
3. SOURCE () : Selection Input Signal button
4. IR Receive Remote Control: Aim the remote control towards this spot on the LED Display.
- ③ USB 1 Terminal (Direct connect to PC)
- ④ USB 2 Terminal (Direct connect to PC)



1 2 3 4

3.2 Rear View



INTERFACE	DESCRIPTION
DP	DISPLAY PORT Input- up to UHD Input
UHD HDMI	High Definition Multimedia Input- up to UHD input
AUDIO IN	Audio IN for DVI and PC source
PC-RGB	PC Screen Input
FHD HDMI 2	High Definition Multimedia Input- up to FHD input, Support MHL
FHD HDMI 1	High Definition Multimedia Input- up to FHD input
DVI	High Definition Multimedia Input
RS-232C	Facility to control the screen via RS232 protocol
USB	Download-software update, Play contents
USB OPTION	When connecting the USB for touch dual touch
USB for touch	External PC using USB touch sensor connection

Notes

Be careful when using an OPS computer. See OSD menu descriptions, never turn OPS on (ENABLE) when no OPS computer is in the display.

4. Remote Controller



Key Name	Description
POWER	Power ON/OFF.
SOURCE	Activates OSD menu of input source selecting. Navigates input source.
PC	PC.
AV	AV.
HDMI	HDMI 1, HDMI 2, HDMI 3.
PSM	Picture mode: Standard, Dynamic, Soft,User.
SSM	Sound mode: Standard, Flat, Music, Movie.
MENU	Activates main OSD menu.
EXIT	Escapes main OSD menu.
FREEZE	Videos are saved with pictures.
MUTE	Toggles sound status of speaker.
ECO	Screen Bright.
SLEEP	Set the sleep timer.
INFO	Displays input source information.
ZOOM	Activates OSD of aspect ratio control.
⏮	Fast Backward function (contents play).
▶	Same as "PLAY" on keypad.
⏭	Fast Forward function (contents play).
⏮	Move before contents play mode (contents play).
■	Stop function (contents play).
⏭	Move next contents play mode (contents play).
^	Navigates upper menu in main OSD menu. Navigates input source.
v	Navigates down menu in main OSD menu. Navigates input source
+	Increases sound volume of speaker. Same as "+ Key" on keypad. Navigates next menu in main OSD menu.
-	Decreases sound volume of speaker. Same as "-Key" on keypad. Navigates before menu in main OSD menu.

4.1 How to insert battery.

Insert the battery into proper polarities

Battery model:(CR-2025 3V)

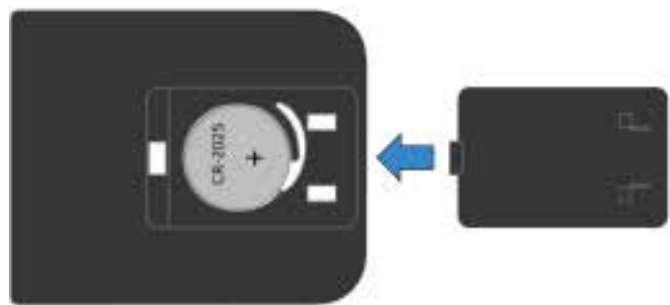

5. OSD MENU

5.1. MENU STRUCTURE

In this menu system, there are several ways to customize the menu settings provided.

Most menus consist of three levels to set up the options, but some require greater depth for the variety of settings. If you press the **MENU** button, only the first and second level of the menu system will appear on the monitor screen. The third level can be displayed by pressing **SELECT**. If a menu has more than three levels, the pop-up dialogue box will be displayed as the fourth or fifth level.

1) To show and remove the Menu:

Press the **MENU** button on the Remote Control to display the menu. A second press of the **MENU** button or a press of the **EXIT** button will take you back to monitor viewing.

2) To go to the next level:

Press **OK** on the Remote Control.

3) To go back to the previous level:

Press **MENU** on the Remote Control.

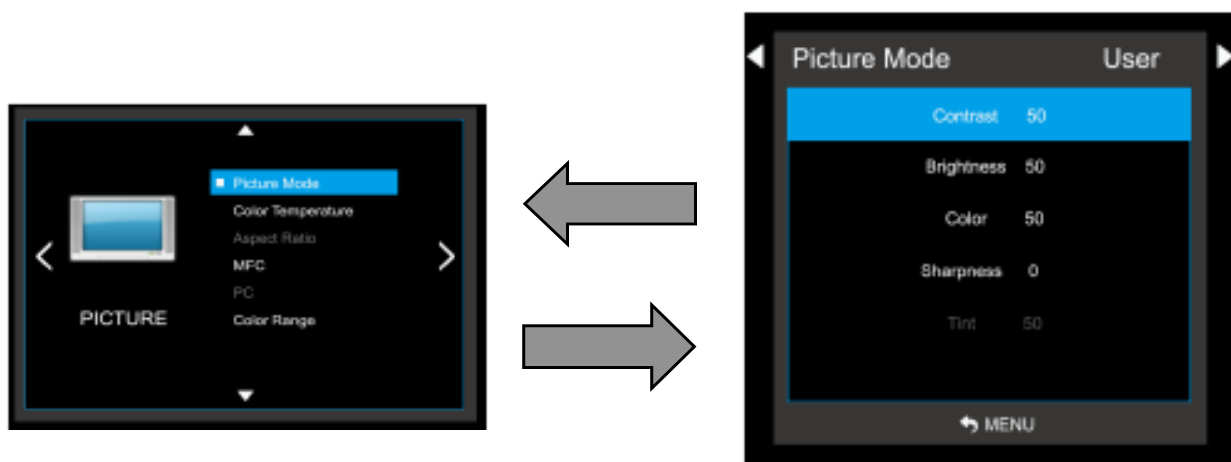

4) Typical Menu Operation

1. Press **MENU** button: The main menu will appear.
2. Use ▲ / ▼ to select the desired menu option (icon).
3. While the desired menu option is selected, press **OK** to move to the second level.
4. Press **OK** to move to the third level: Some menu options require additional steps.
5. Press **MENU** to return to the previous menu.

5.2. Video Input Selection

1) How to select a video source from the OSD

1. Select a ◀ / ▶ button you can click the **SOURCE** button to select each video source.
2. To go to the desired video source, press the **OK** button.

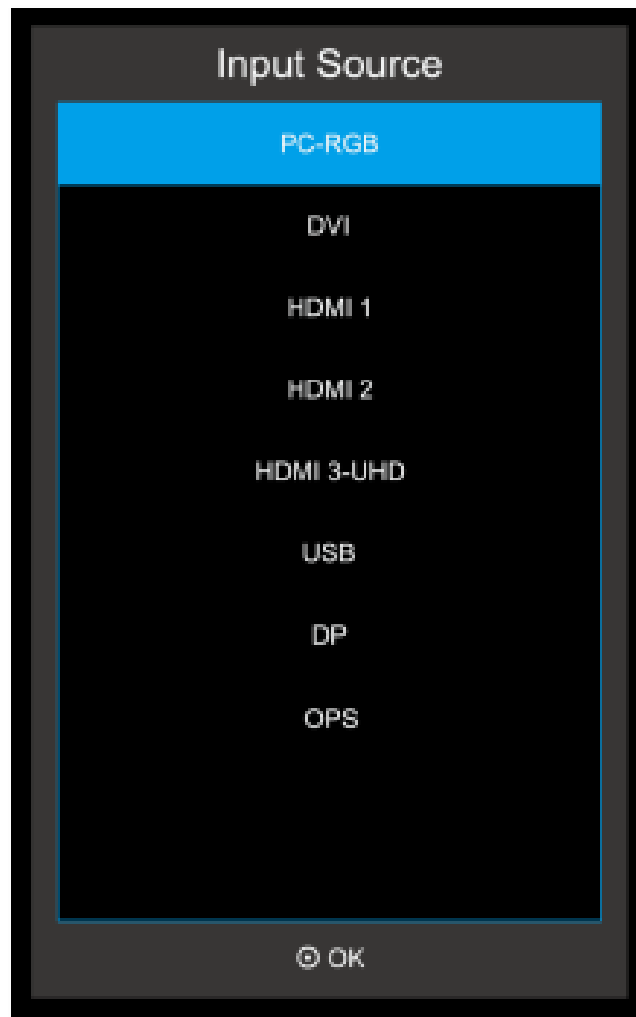

Remark

The source "OPS" as indicated at the bottom of above image will only be displayed in the source selection list if OPS mode is enabled. However if you do not have an OPS computer, do not turn on the OPS mode!

5.3 Select menu language

On Screen Menus Language Selection

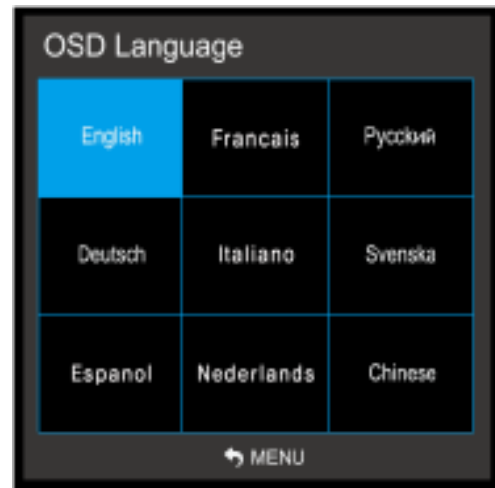

- The menus can be shown on the screen in the selected language. First select your language.

1. Press the **MENU** button and then use ▲ / ▼ button to select the **OPTION** icon.
2. Press the ▲ / ▼ button to select **Menu Language** menu.
3. Press the **OK** button and then use ▲ / ▼ / ◀ / ▶ button to select your desired language:
From this point on, the on-screen menus will be shown in the selected language.
4. Press **MENU** to return to the previous menu.

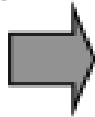

Supported Languages

English, Francais, Italiano, Nederlands, Espanol, Chinese, etc.

5.4 On Screen Menu options

5.4.1 How to adjust the OSD screen

2. Press the **MENU** button and then ◀/▶ button to select each menu.
3. Press the **OK** button and then use ▲/▼ button to display the available menus.

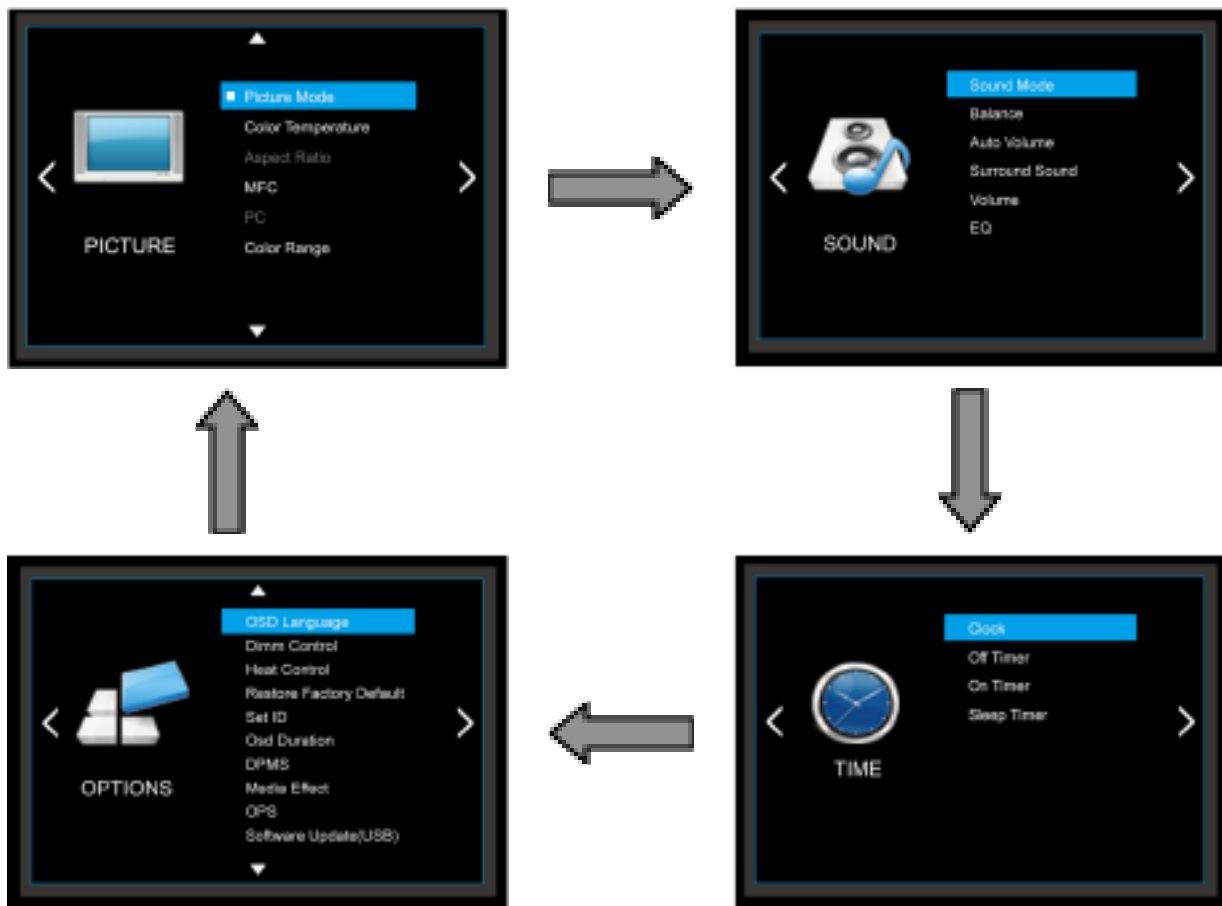

• Your monitor's OSD (On Screen Display) may differ slightly from what is shown in this manual.

5.4.2 PICTURE MENU OPTIONS

1) Picture Mode

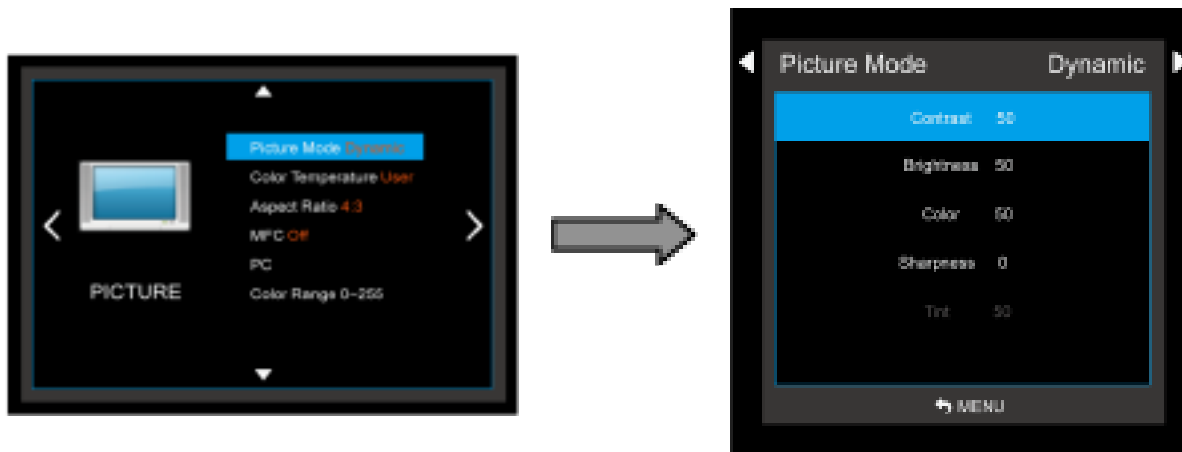

- Adjust the picture appearance to suit your preference and viewing situations.

1. Press the **MENU** button and then ◀/▶ button to select the **PICTURE** mode.
2. Press the ◀/▶ button and then use **OK** button to select **Picture Mode** menu.
Standard, Dynamic, Mild, User
3. Press the ▲/▼ button to select **Picture Mode - User** menu
Contrast, Brightness, Color, Sharpness, Tint.
4. Press **OK** button and then use ◀/▶ button to make appropriate adjustments.
5. Press **MENU** to return to the previous menu.

- Contrast : Control the difference between the bright and dark regions of the screen picture. **(Only user-mode Support)**

- Brightness: Adjust brightness of the picture. **(Only user-mode Support)**

- Color: Adjust color of the picture. **(Only user-mode Support)**

- Sharpness: Set the amount of fine detail in the picture. **(Only user-mode Support)**

- Tint: Control the fresh tones to make them appear natural. **(Does not work in any mode)**

2) Color Temperature Control

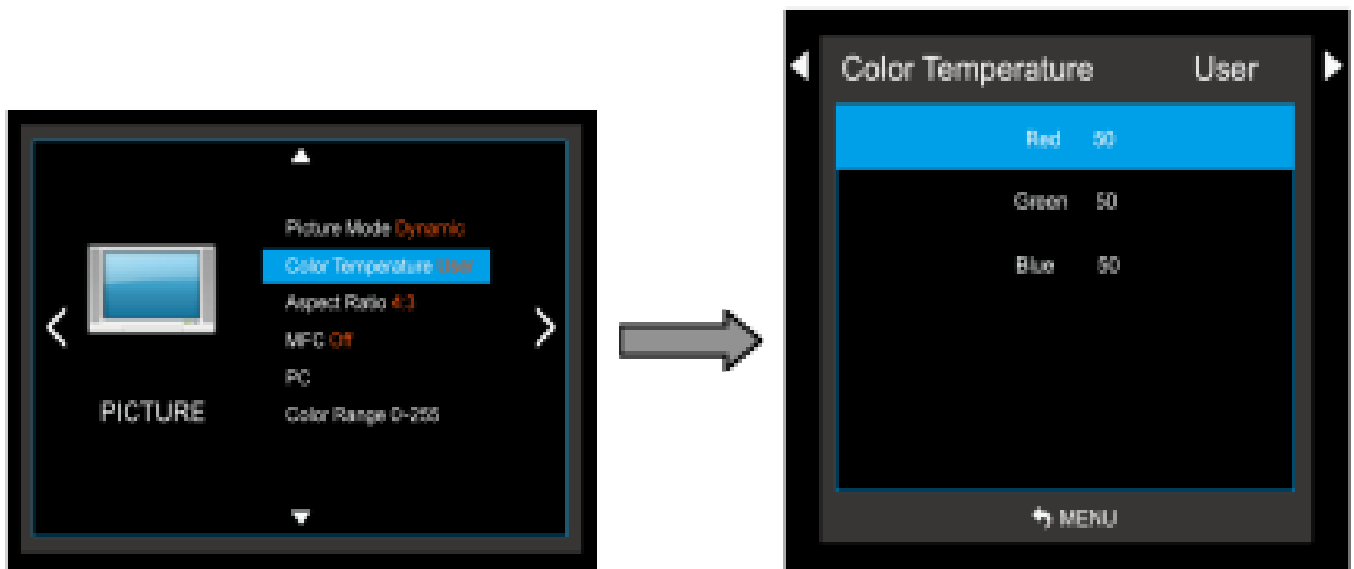

- Choose one of five automatic color adjustments. Set to warm to enhance hotter colors such as red, or set to cool to see less intense colors with more blue.

1. Press the **MENU** button and then use ◀/▶ button to select the **PICTURE** icon.
2. Press the ▲/▼ button and then use **ENTER** button to select Color **Temperature** menu.
3. Press the **OK** button and then use ◀/▶ button to select desired option:
User, Cool, Medium, Warm.
4. Press the ▲/▼ button to select **Picture Mode - User** menu.
Red, Green, Blue
5. Press **MENU** to return to the previous menu.

- Color Temperature : select between Normal, Cool and Warm. **(Only user-mode Support)**

3) Aspect Ratio

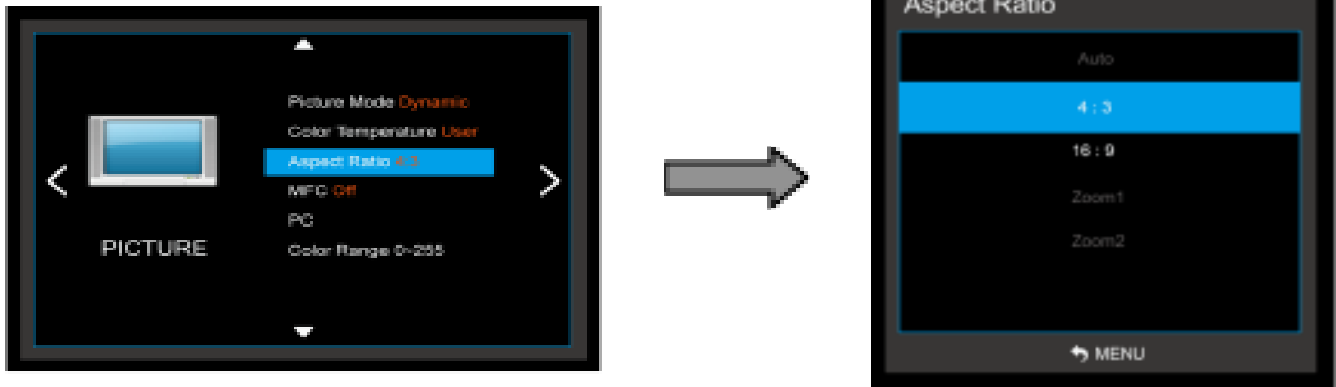

- Selects the screen format.

1. Press the **MENU** button and then use ◀/▶ button to select the **PICTURE** icon.
2. Press the ▲/▼ button and then use **OK** button to select **Aspect Ratio** menu.
3. Press the **OK** button and then use ▲/▼ button to select desired option:
Auto, 4:3, 16:9, Zoom1, Zoom2.
->When using a DVI unput, only the 4:3 and 16:9 aspect ratios are available
4. Press **MENU** to return to the previous menu.

4) MFC

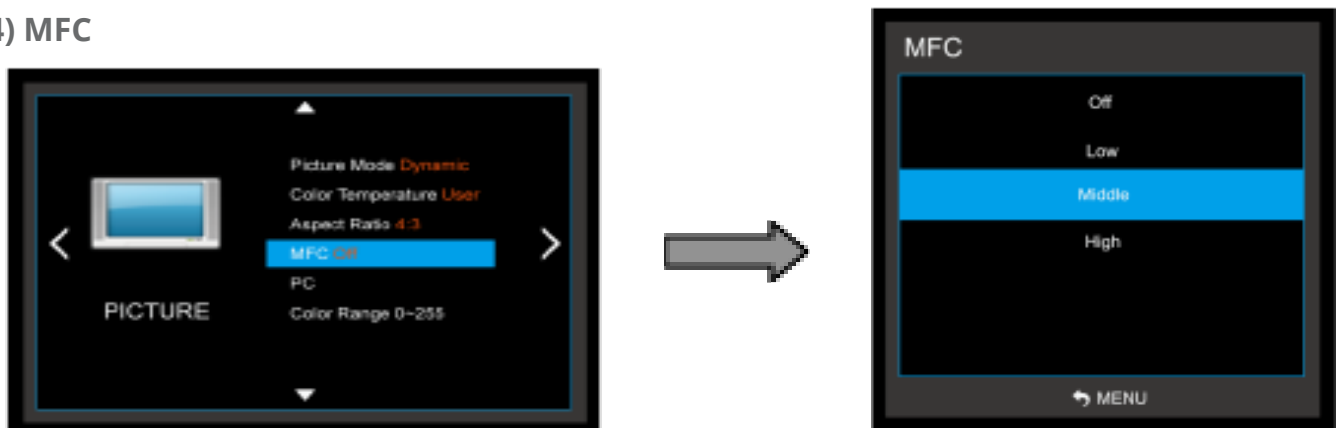

- Select the picture appearance to suit your preference and viewing situations.

1. Press the **MENU** button and then ◀/▶ button to select the **PICTURE** icon.
2. Press the ▲/▼ button and then use **OK** button to select **MFC** menu
3. Press the **OK** button and then use button to select the desired picture option;
Off, Low, Middle, High, Default.
4. Press **MENU** to return to the previous menu.

- MFC** - when the video screen is set on HIGH, it is possible that the image will be broken
- Touch Speed is Degraded
 - Motion compensated Frame Rate Conversion
 - JUDDER phenomenon occurs in the video, it is possible to change the setting to HIGH.

5) PC Menu

The PC menu can only be selected when the video input is VGA !



1. Press the **MENU** button and then use ◀ / ▶ button to select the **PICTURE** icon.
2. Press the ▲ / ▼ button and then use **OK** button to select **PC Menu**.
3. Press ▲ / ▼ button and then use ◀ / ▶ button to make appropriate adjustments.
4. Press **MENU** to return to the previous menu.

6) Color Range

1. Press the **OK** button. [Range scaling changes from 16-234 to 0-255]

-> color range can not be changed when display is used in USB mode (USB media port) or PC mode (VGA-cable).

5.4.3 SOUND MENU OPTIONS

1) Sound Standard Mode

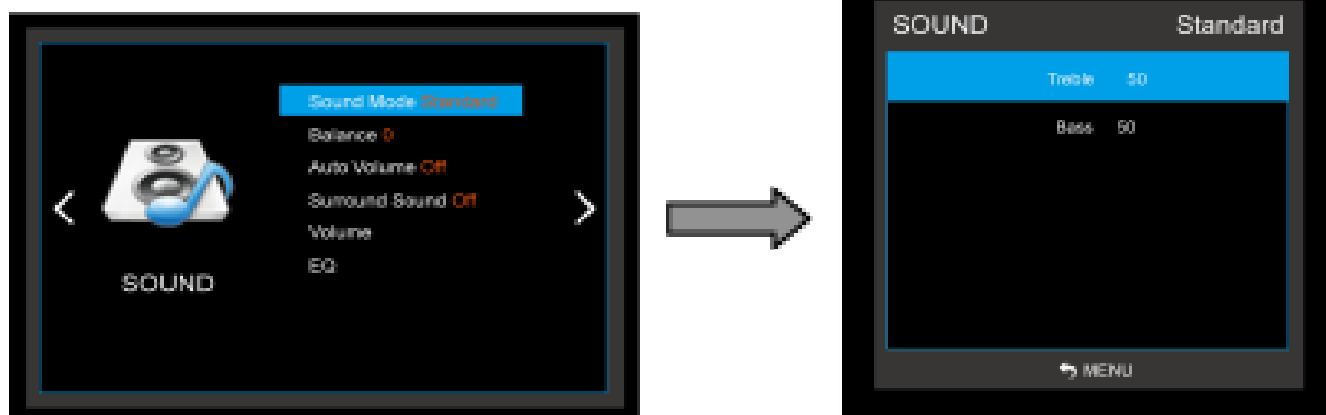

- Adjust the sound to suit your taste and room situations.

1. Press the **MENU** button and then use ◀/▶ button to select the **SOUND** icon.
2. Press the ▲/▼ button and then use **OK** button to select **Sound Mode** menu : **Standard, Music, Movie, Sports, User.**
3. Press the ◀/▶ button and then use ▲/▼ button to select - **User** menu : **Treble, Bass.**
4. Press **MENU** to return to the previous menu.

- Treble: Controls the relative intensity of higher pitched sounds. (Only user-mode Support)
- Bass: Controls the relative intensity of lower pitched sounds. (Only user-mode Support)

2) Sound Balance

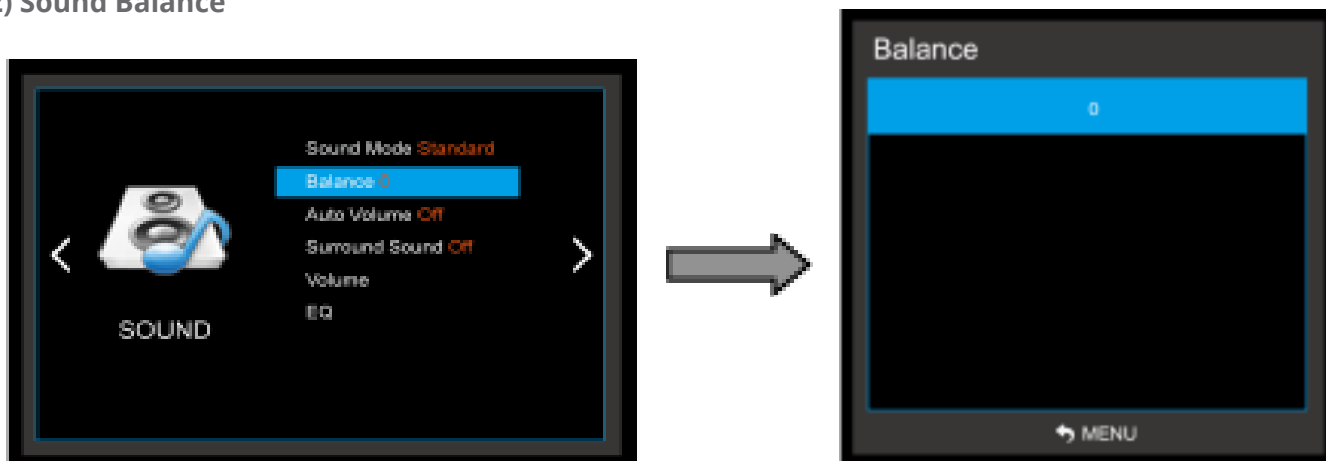

- Adjust the sound to suit your taste and room situations.

1. Press the **MENU** button and then use ◀/▶ button to select the **SOUND** icon.
2. Press the ▲/▼ button and then use **OK** button to select the **Balance** menu.
3. Press ◀/▶ button to make appropriate adjustments. **[L50 ~ 0 ~ R50]**
4. Press **MENU** to return to the previous menu.

3) Auto Volume – Automatic Volume Limit System: For protecting the hearing

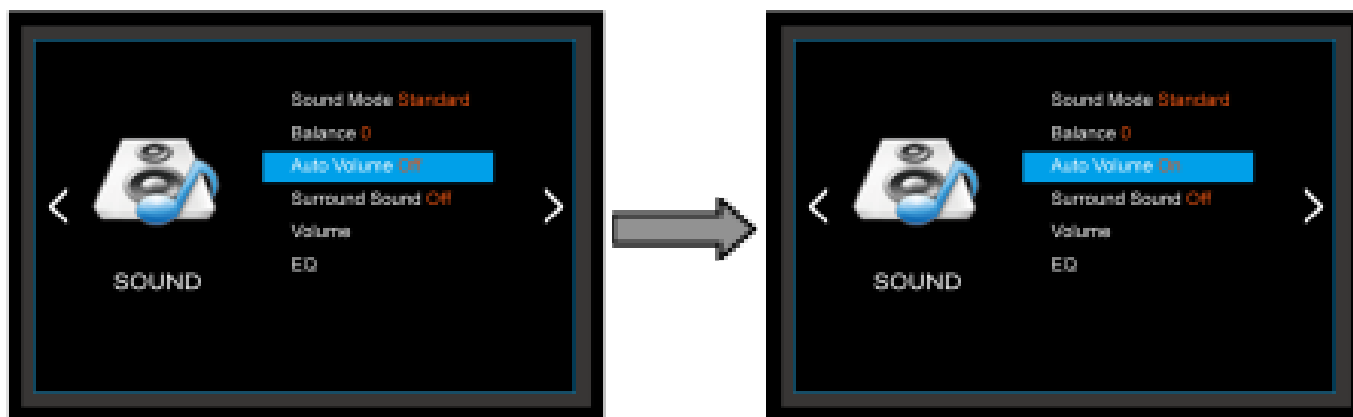

- Adjust the sound to suit your taste and room situations.

1. Press the **MENU** button and then use ◀/▶ button to select the **SOUND** icon.
2. Press the ▲/▼ button and then use **OK** button to select the **Auto Volume** menu.
3. Press **OK** button to make appropriate adjustments : **On, Off**
4. Press **MENU** to return to the previous menu.

4) Surround Sound

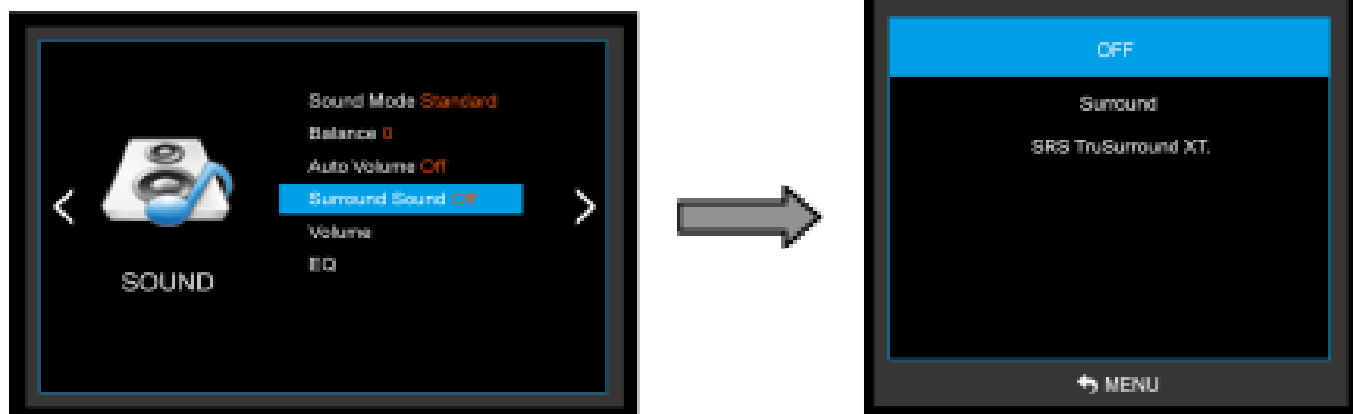

- Adjust the sound to suit your taste and room situations.

1. Press the **MENU** button and then use ◀/▶ button to select the **SOUND** icon.
2. Press the ▲/▼ button and then use **OK** button to select the **Surround Sound** menu.
3. Press the ▲/▼ button **OK** button to make appropriate adjustments :
4. Press **MENU** to return to the previous menu.

5) Volume

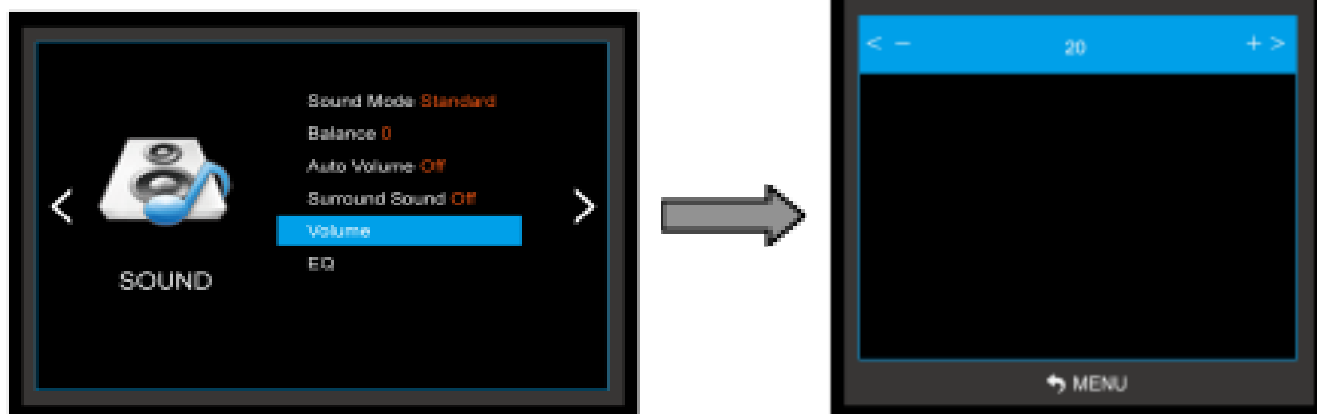

- Adjust the sound to suit your taste and room situations.

1. Press the **MENU** button and then use ◀ / ▶ button to select the **SOUND** icon.
2. Press the ▲ / ▼ button to select the **Volume** menu.
3. Press **OK** button and then use ◀ / ▶ button to make appropriate adjustments. [0 ~ 100]
4. Press **MENU** to return to the previous menu.

6) User Control for 5 Band Equalizer

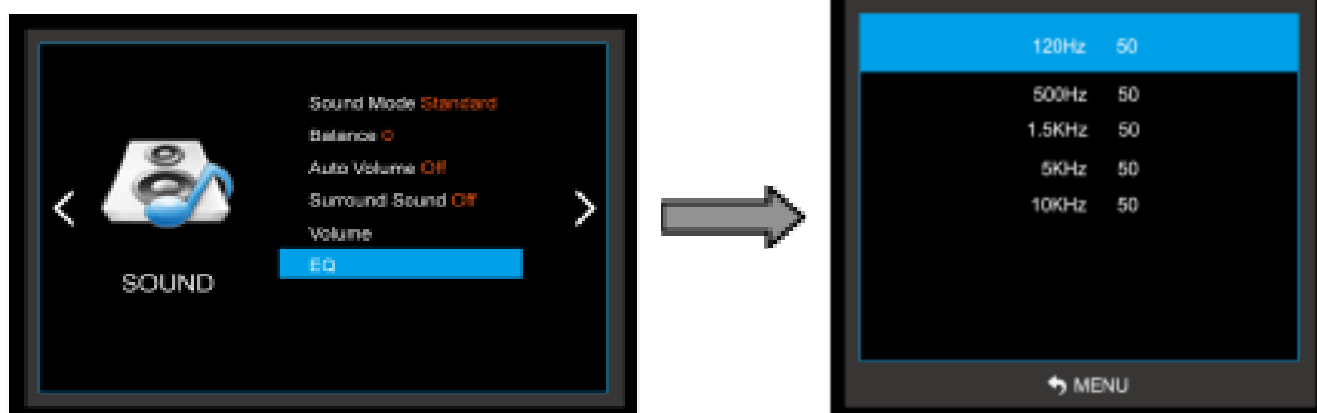

- If the Equalizer settings are changed, sound mode setting goes to **User** automatically.

1. Press the **MENU** button and then use ◀ / ▶ button to select the **SOUND** icon.
2. Press the ▲ / ▼ button to select the **EQ(Equalizer)** menu.
3. Press the **OK** button and then use ◀ / ▶ button to make appropriate adjustments;
120Hz, 500Hz, 1.5KHz, 5KHz, 10KHz.
4. Press **MENU** to return to the previous menu.

5.4.4 SETUP MENU OPTIONS

1) Language

- Select a language for the menus to appear in.

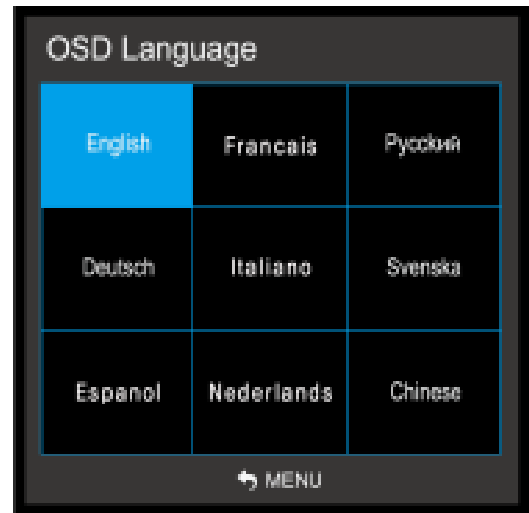
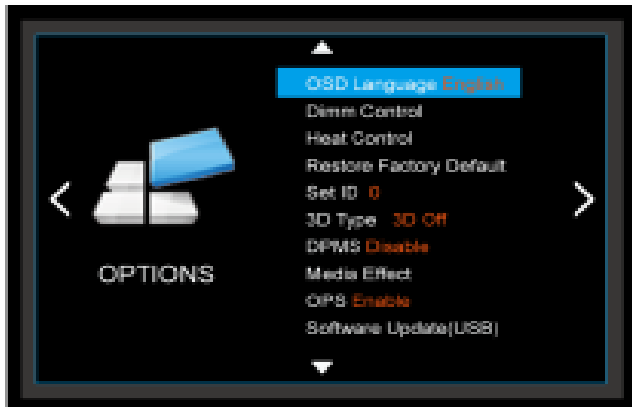

1. Press the **MENU** button and then use ◀/▶ button to select the **OPTION** icon.
2. Press the ▲/▼ button to select the **OSD Language** menu.
3. Press the **OK** button and then use ▲/▼/◀/▶ button to select the desired option:

Supports Language

English, Franais, Espanol, Deutsch, Italiano, Nederlands, Chinese, etc.

4. Press **MENU** to return to the previous menu.

2) Dimm Control

2-1) Dimming

- Automatic dimming controls by Adjusting the brightness of the set in Dimming menu.

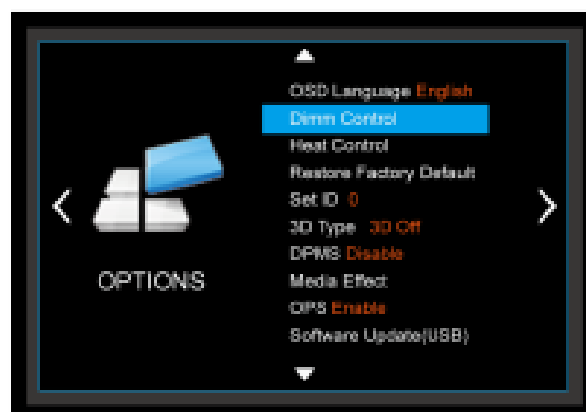

1. Press the **MENU** button and then use ◀/▶ button to select the **OPTION** icon.
2. Press the ▲/▼ button to select the **Dimm Control** Menu.
3. Press the **OK** button and then use ▲/▼ button to select the **Dimming Menu**.
4. Press the ▲/▼/◀/▶ button to set Dimming options.
5. Press **MENU** to return to the previous menu.

2-1-1) Dimming Menu – Auto Dimming (Light Ambient Sensor Option only)

- Enable/disables auto dimming control by light ambient sensor



1. Press the **MENU** button and then use ◀ / ▶ button to select the **OPTION** icon.
2. Press the ▲ / ▼ button to select the **Dimm Control** Menu.
3. Press the OK button and then use ▲ / ▼ button to select the **Dimming Menu**.
4. Press the ▲ / ▼ button to select the **Auto Dimming** functions.
5. Press the ◀ / ▶ button to set Auto Dimming options.
6. Press **MENU** to return to the previous menu.

ON : Dim level is adjusted by light sensor (automatic control system)

OFF : Dim level is adjusted by manual control (manual control system)

2-1-2) Dim Level : Auto Dimming - off

- Controls Inverter dimming level – Inverter brightness control.

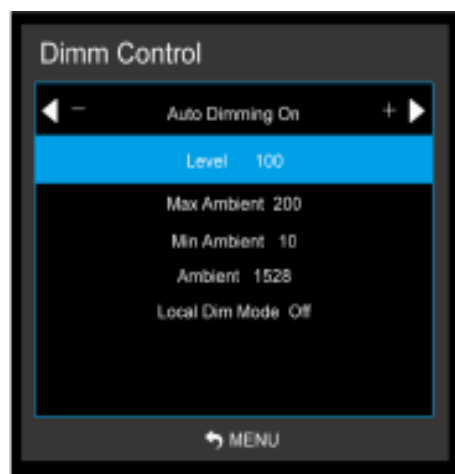

1. Press the **MENU** button and then use ◀ / ▶ button to select the **OPTION** icon.
2. Press the ▲ / ▼ button to select the **Dimm Control** Menu.
3. Press the **OK** button and then use ▲ / ▼ button to select the **Dimming Menu**.
4. Press the ▲ / ▼ button to select the **Level** functions.
5. Press the ◀ / ▶ button to set **Level** functions.
6. Press **MENU** to return to the previous menu.

2-1-3) Dimming Menu – MAX Ambient (Light Ambient Sensor Option only)

- Adjusts detected light ambient to set the maximum dimming

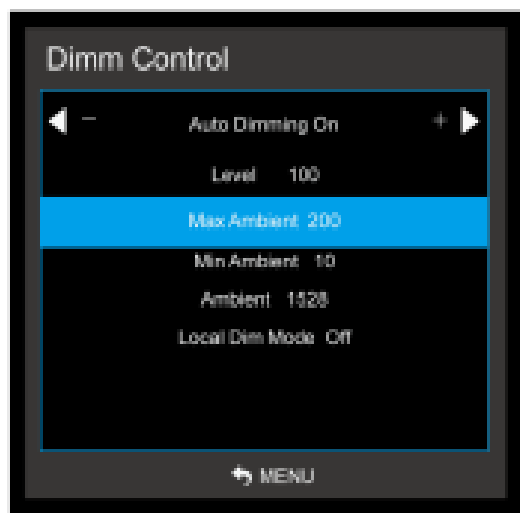

1. Press the **MENU** button and then use ◀/▶ button to select the **OPTION** icon.
2. Press the ▲/▼ button to select the **Dimm Control** Menu.
3. Press the OK button and then use ▲/▼ button to select the **Dimming** Menu.
4. Press the ▲/▼ button to select the **Max Ambient** functions.
5. Use ◀/▶ button to set detected light ambient value by LUX unit.
6. Press **MENU** to return to the previous menu.

2-1-4) Dimming Menu – MIN Ambient (Light Ambient Sensor Option only)

- Adjusts detected light ambient to set the minimum dimming

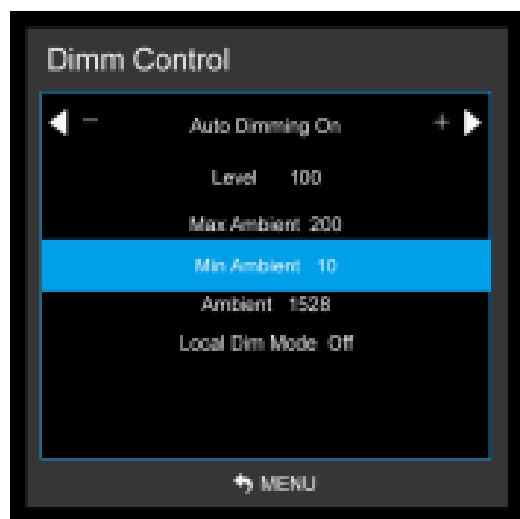

1. Press the **MENU** button and then use ◀/▶ button to select the **OPTION** icon.
2. Press the ▲/▼ button to select the **Dimm Control** Menu.
3. Press the **OK** button and then use ▲/▼ button to select the **Dimming** Menu.
4. Press the ▲/▼ button to select the **Min Ambient** functions.
5. Use ◀/▶ button to set detected light ambient value by LUX unit.
6. Press **MENU** to return to the previous menu.

2-1-5) Dimming Menu – Ambient (Light Ambient Sensor Option only)

- Displays current detected light ambient level by LUX unit. Read Only.



3) Heat Control

- Automatic Fan controls by internal/external temperature sensor



1. Press the **MENU** button and then use ◀ / ▶ button to select the **OPTION** icon.
2. Press the ▲ / ▼ button to select the **Heat Control** Menu.
3. Press the **OK** button and then use ▲ / ▼ / ◀ / ▶ button to set Heat Control options.
4. Press **MENU** to return to the previous menu.

3-1) Heat Control Menu – Fan Control

- Controls fan driving option by temperature sensor / force on / force off

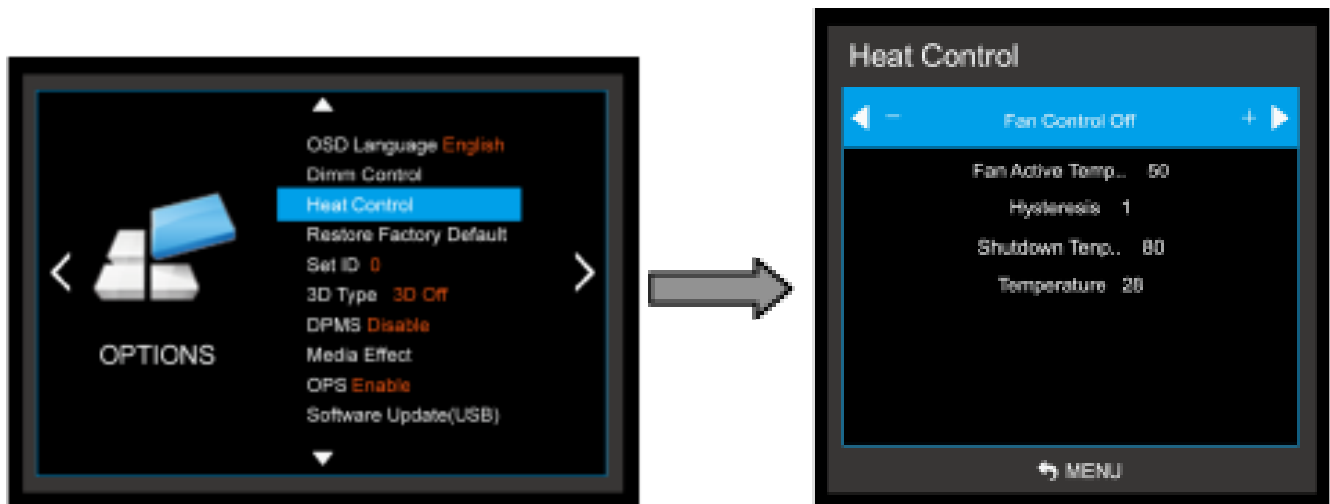

1. Press the **MENU** button and then use ◀ / ▶ button to select the **OPTION** icon.
2. Press the ▲ / ▼ button to select the **Heat Control** Menu.
3. Press the **OK** button and then use ▲ / ▼ button to select the **Fan Control** functions.
4. Press the ◀ / ▶ button to set **Off, On, Auto** options.
5. Press **MENU** to return to the previous menu.

3-2) Heat Control Menu – Fan Active Temperature

- Adjusts fan driving temperature by Celsius degree. It works only when the Fan Control setting is **Auto**.

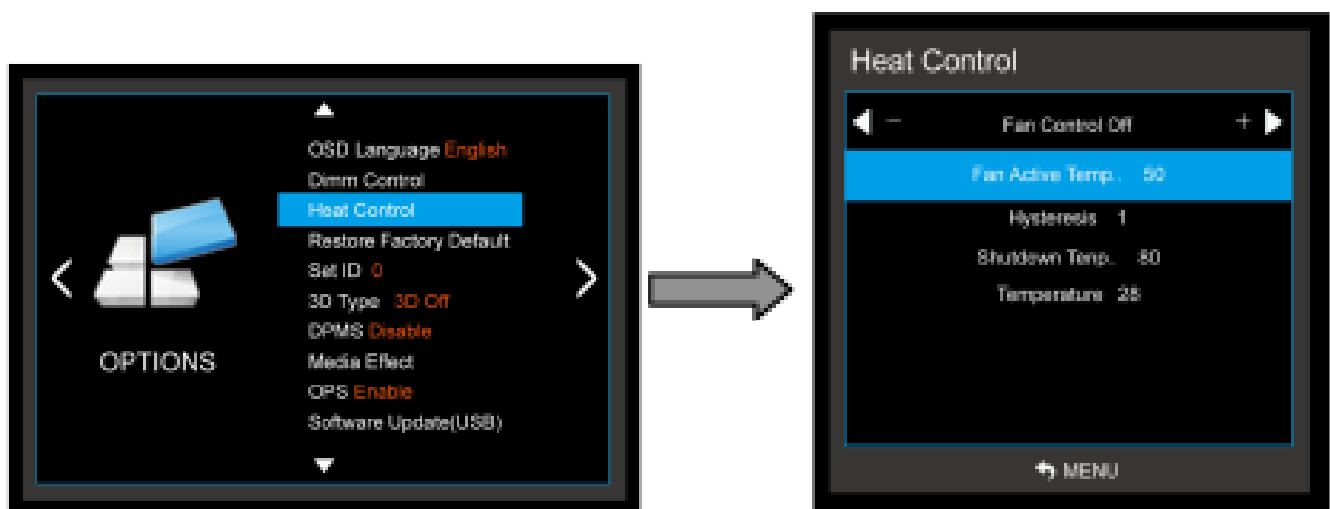

1. Press the **MENU** button and then use ◀ / ▶ button to select the **OPTION** icon.
2. Press the ▲ / ▼ button to select the **Heat Control** Menu.
3. Press the **OK** button and then use ▲ / ▼ button to select the **Fan Active Temperature** Menu.
4. Use ◀ / ▶ button to set fan driving temperature by Celsius degree unit.
5. Press **MENU** to return to the previous menu.

3-3) Heat Control Menu – Hysteresis

- Adjusts fan driving hysteresis temperature by Celsius degree.

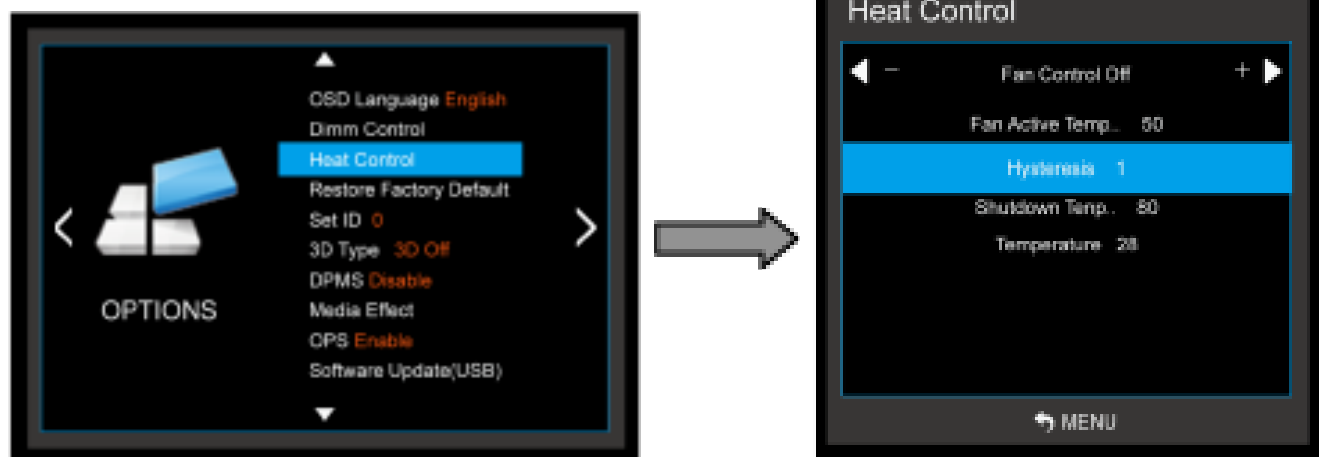

1. Press the **MENU** button and then use ◀/▶ button to select the **OPTION** icon.
2. Press the ▲/▼ button to select the **Heat Control** Menu..
3. Press the **OK** button and then use ▲/▼ button to select the **Hysteresis** Menu.
4. Use ◀/▶ button to set fan driving hysteresis temperature by Celsius degree unit.
5. Press **MENU** to return to the previous menu.

3-4) Heat Control – Shutdown

- Adjusts shutdown mode temperature by Celsius degree.

When current temperature reaches the shutdown temp, the monitor enters shutdown mode.

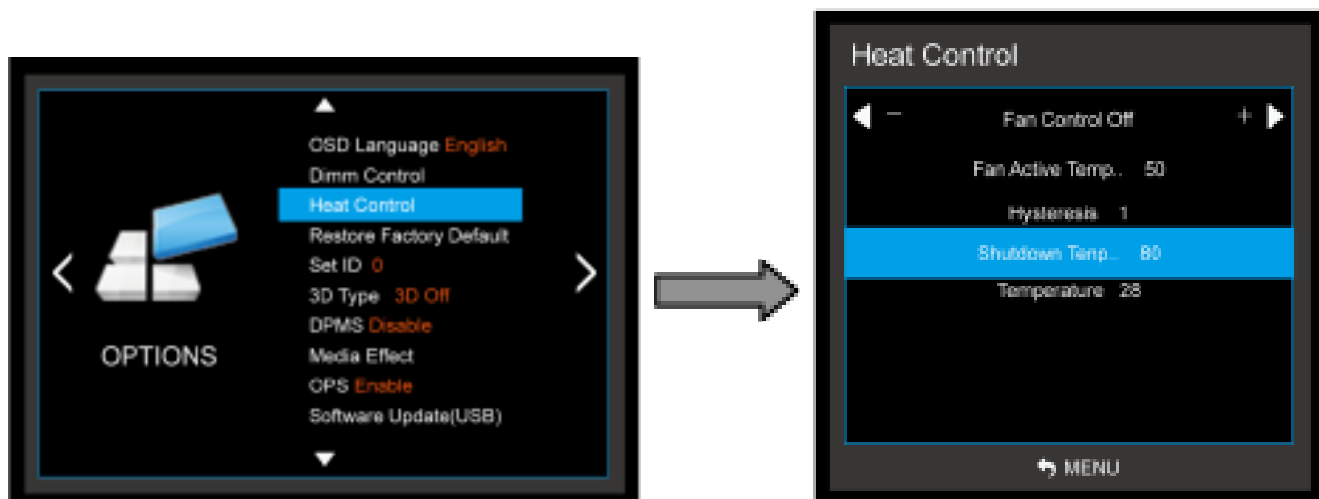

1. Press the **MENU** button and then use ◀/▶ button to select the **OPTION** icon.
2. Press the ▲/▼ button to select the **Heat Control** Menu.
3. Press the **OK** button and then use ▲/▼ button to select the **shutdown** Menu.
4. Use ◀/▶ button to set fan driving hysteresis temperature by Celsius degree unit.
5. Press **MENU** to return to the previous menu.

3-5) Heat Control – Current temperature

- Displays current detected main sensor's temperature and auxiliary sensor's (option) temperature Read Only.

4) Reset

Resets user setting values as default

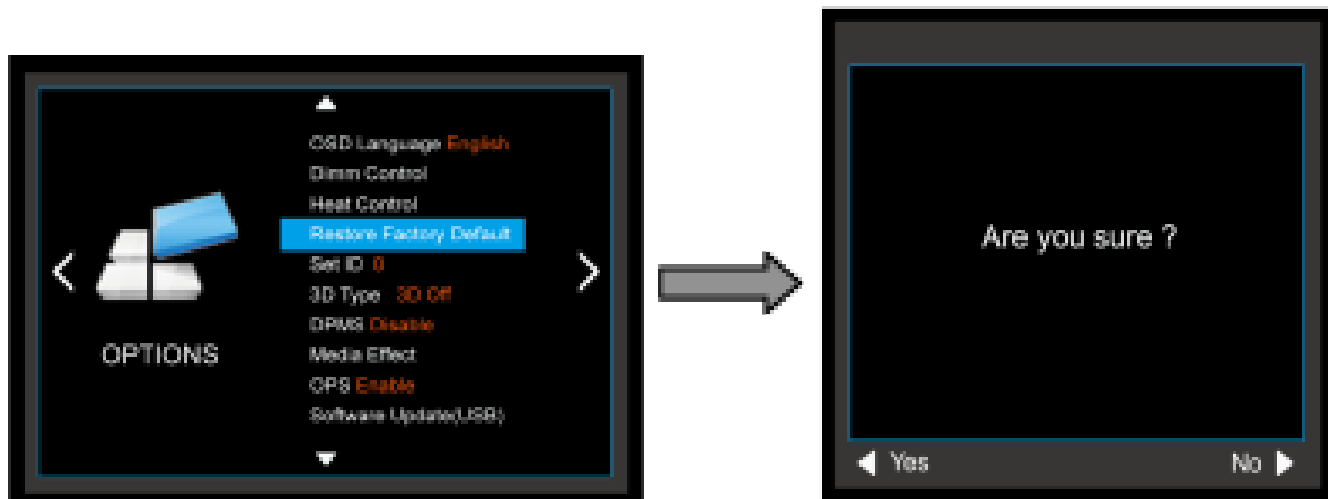

1. Press the **MENU** button and then use ◀/▶ button to select the **OPTION** icon.
2. Press the ▲/▼ button to select **Restore Factory Default** menu
3. Press the **OK** button and then use ▲/▼ button to select the **Are you sure?** menu.
4. Press **MENU** to return to the previous menu.

5) Set ID

Number assigned to the SET in RS-232C communication.

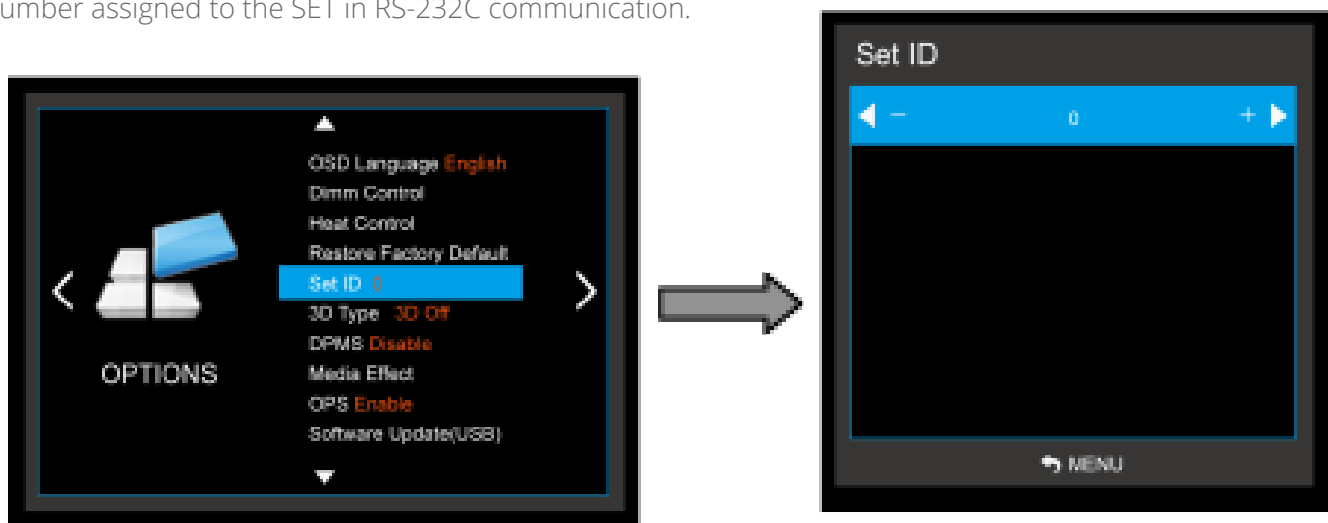

1. Press the **MENU** button and then use ◀/▶ button to select the **OPTION** icon.
2. Press the ▲/▼ button to select **Set ID** menu
3. Press ◀/▶ button to make appropriate adjustments. [0 ~ +99]
4. Press **MENU** to return to the previous menu.

6) 3D Type

3D used and whether adjustments.

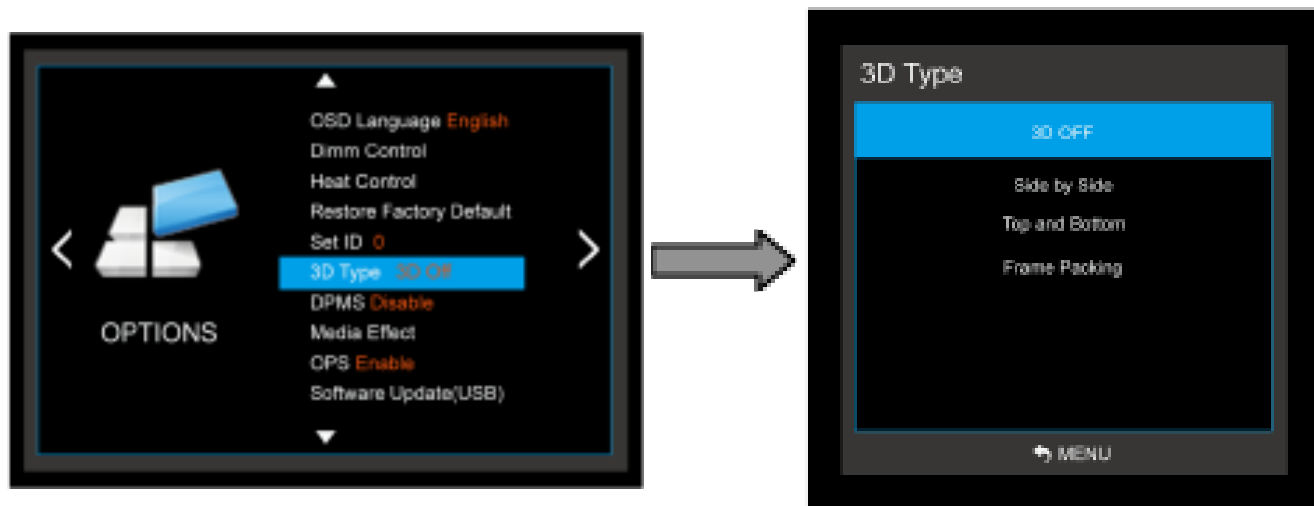

1. Press the **MENU** button and then use ◀ / ▶ button to select the **OPTION** icon.
2. Press the ▲ / ▼ button to select **3D Type** menu
3. Press the **OK** button to select the Details Menu : **3D OFF, Side by Side, Top and Bottom, Frame Packing.**
4. Press **MENU** to return to the previous menu.

7) DPMS

Shut off the panel power after the input source has been unused for some time (idle), to save power.

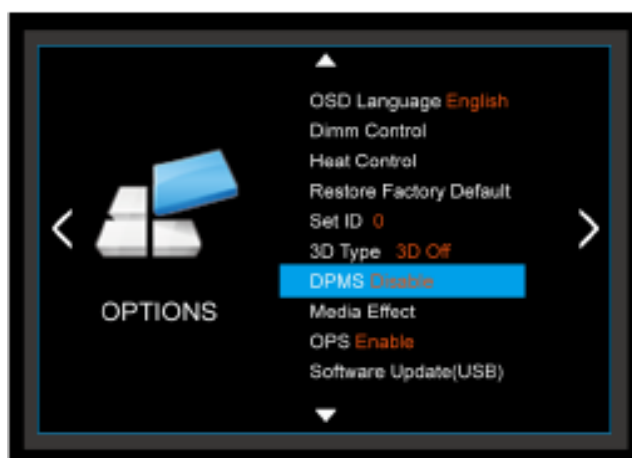

1. Press the **MENU** button and then use ◀ / ▶ button to select the **OPTION** icon.
2. Press the ▲ / ▼ button to select **DPMS** menu
3. Press the **OK** button to select the Details Menu : **ON, OFF**
4. Press **MENU** to return to the previous menu.

8) Media Effect

- Adjusting the slideshow effect in picture playback of USB mode.

-> **Photo playback applies only**

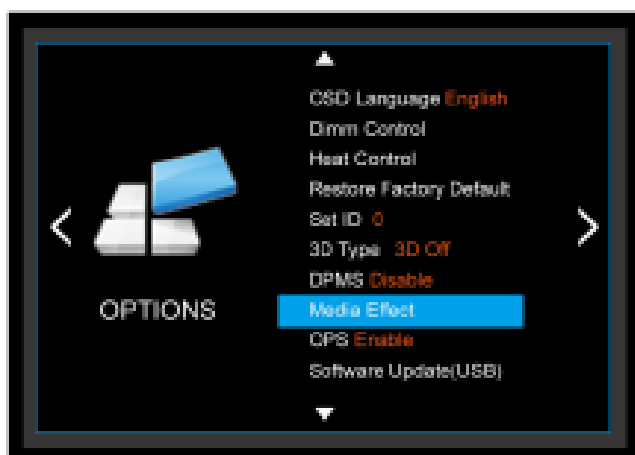

9) OPS

Whether to use OPS PC adjustment

Warning: Do not change the OPS mode.

OPS should be Disabled and left Disabled at all times, unless a OPS computer is used!

1. Press the **MENU** button and then use ◀ / ▶ button to select the **OPTION** icon.
2. Press the ▲ / ▼ button to select **OPS** menu
3. Press the OK button to select the Details Menu

: Disable, Enable

4. Press **MENU** to return to the previous menu.

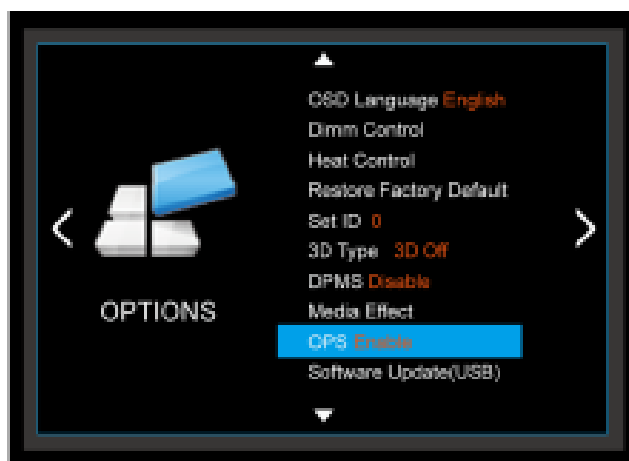

10) Software Update (USB)

Warning: Only use Software Update if your technical support contact provided you a firmware update for the display. If you use this update without a USB stick with a new firmware-version, you risk to damage the display!



5.5 CLOCK MENU

1) Time Settings

Enable the user to set up the clock information.



1-1) Clock

If current time setting is wrong, reset the clock manually.

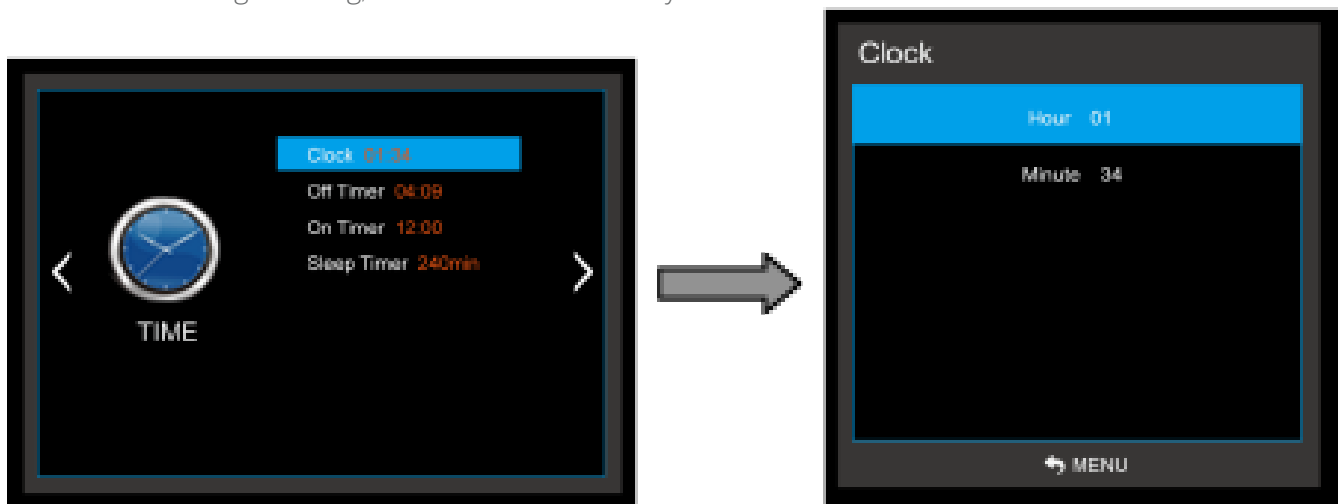

1. Press the **MENU** button and then use ◀ / ▶ button to select the **TIME** icon.
2. Press the **OK** button and then use ▲ / ▼ button to select **Clock**.
3. Press the ▲ / ▼ button to select the **Hour, Minute**.
4. Use ◀ / ▶ button to adjust clock.
5. Press **MENU** to return to the previous menu.

2) On Timer

Timer function operates only if current time has been set.

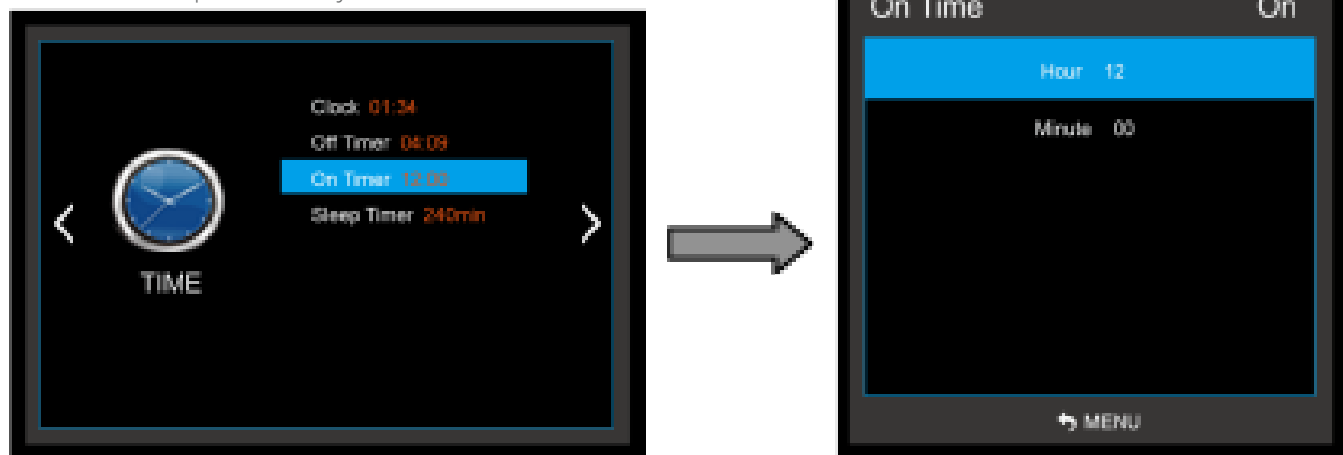

1. Press the **MENU** button and then use ◀ / ▶ button to select the **TIME** icon.
2. Press the ▲ / ▼ button to select **On Timer**.
3. Press the **OK** button and then use ◀ / ▶ button to select the **On, Off**.
4. Use ▲ / ▼ button, ◀ / ▶ button to adjust on time schedule and activation.
5. Press **MENU** to return to the previous menu.

3) Off Timer

Timer function operates only if current time has been set.

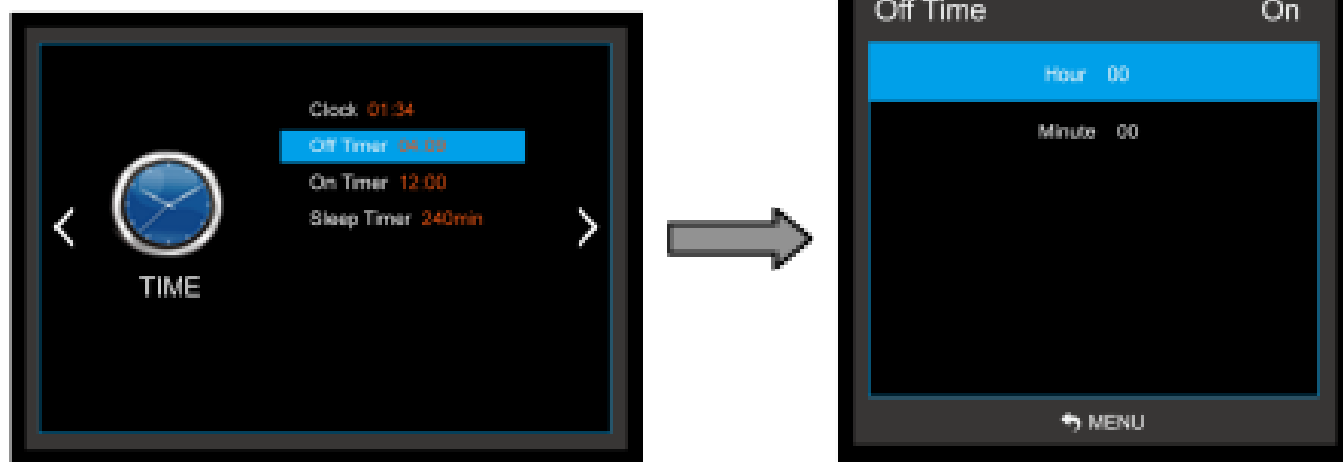

1. Press the **MENU** button and then use ◀ / ▶ button to select the **TIME** icon.
2. Press the **OK** button and then use ▲ / ▼ button to select **Off Timer**.
3. Press the ▶ button and then use ◀ / ▶ button to select the **On, OFF**.
4. Use ▲ / ▼ button, ◀ / ▶ button to adjust off time schedule and activation.
5. Press **MENU** to return to the previous menu.

4) Sleep Timer

Timer function operates only if current time has been set.

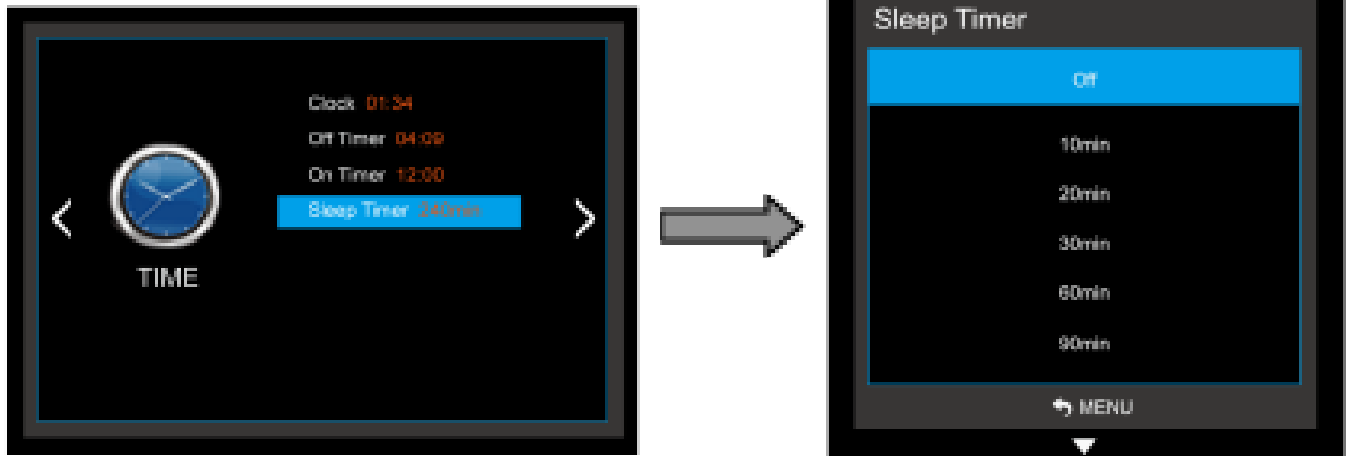

1. Press the **MENU** button and then use ◀ / ▶ button to select the **TIME** icon.
2. Press the ▲ / ▼ button to select **Sleep Timer**.
3. Press the **OK** button and then use ◀ / ▶ button to select the desired time.
4. Press **MENU** to return to the previous menu.

6 Troubleshooting

The display is not receiving power

If the display is connected with a power cable and the power point (power outlet) being used has electric current, first use another power cable. If the display is still not receiving power and both the single red power button in front of the display and the power on button of the remote control have been tested, please contact your i3 support contact.

The displays is not showing any image

If the display is showing a blank screen and is receiving power but no image is shown, then the display is not receiving any source. Verify the following:

1. Use the "source" button in front of the display or the source buttons on the remote control
2. Check if your computer is sending a signal to an external device (e.g.: a laptop might sometimes not duplicate its image. Press FN + the brand dependent function key of the computer to duplicate the signal. E.g. for DELL this is FN+F8).
3. Check is the video cable (e.g. VGA or HDMI) is firmly connected on the computer and display
4. Use another video cable
5. Check if the video port of the source device (e.g. computer) is working (e.g. by using another projector, monitor,...)
6. Check if the port is not defect (e.g. no image on HDMI2 when HDMI2 is selected, try HDMI3)

If the display is showing "mode not supported", check the resolution and frequency send out from your computer. Set resolution and frequency to the recommended ranges for the display

If this doesn't solve the issue, please contact your i3 support contact

Black borders on screen

When the image on the display is not filling the full screen:

1. Change the resolution of the signal send to the display. Make sure the resolution of the signal send is the optimal resolution of the display (here 16/9).
2. Try to scale the display and computer monitor to "full screen". You can do so via the "advanced settings" of the "screen resolution" menu of your computer's display settings (see service document "full screen scaling for orientation loss"). If you don't manage to get both the computer monitor and the display scaled full screen, only use the display scaled full screen.
3. Check the settings of the display in the on screen display menu (remote control)

If this doesn't solve the issue, please contact your i3 support contact

The display has no sound

Verify the following:

1. If using VGA, check if the separate audio cable is connected
2. If using VGA, check if the audio port of the PC is working (using a speaker set)
3. Check if all sound is turned on (sound of the computer & sound of display. None of them muted)
4. If sound is send via HDMI, check the sound settings of the computer to see if audio on HDMI is not muted.
5. Check if no other external speakers are connected

If this doesn't solve the issue, please contact your i3 support contact

7. Touch configuration

1 Driver download

Go to the i3-Technologies website www.i3-technologies.com and download the latest drivers (products -> drivers -> i3TOUCH drivers)

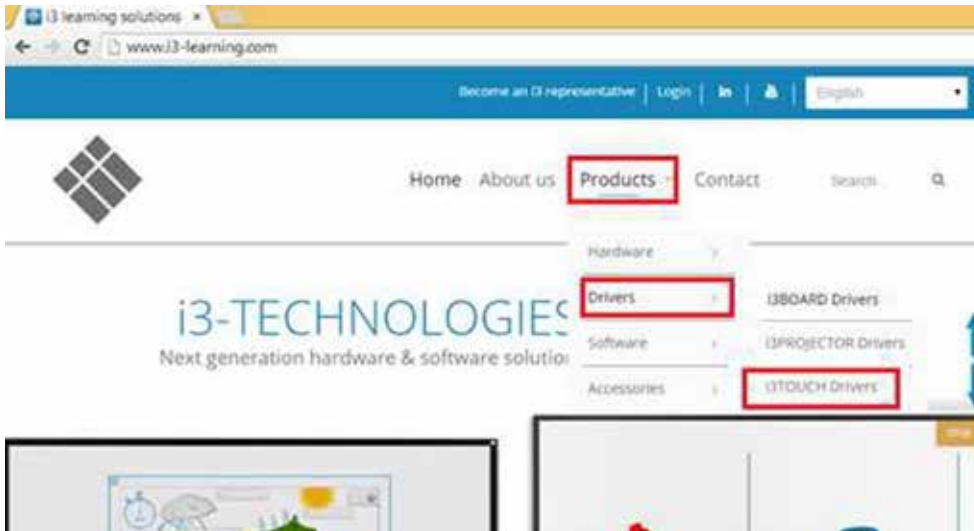

2 Connecting the touch sensor

Connect the port indicated "USB touch" with the supplied USB cable to the computer. If there are 2 USB-ports and one is indicated "USB for touch OPTION", do not use this port as it is disabled.



3 Installing the drivers

install the drivers you downloaded on the website (you will find the driver in the download folder that has been set in your browser preferences).

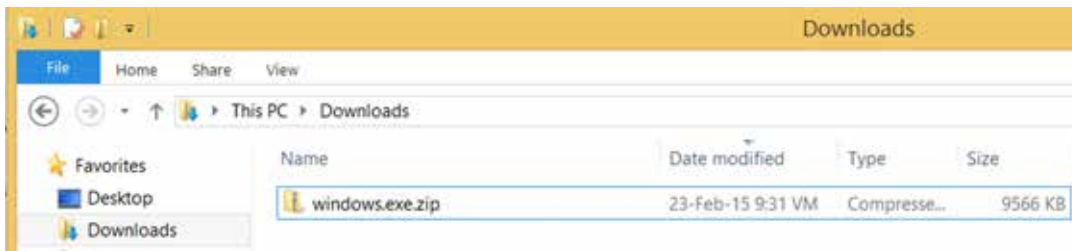

The drivers are compressed in a .ZIP-file. When using windows 7 or higher: double click the file and choose "extract all". Extract the content of the folder on your PC.

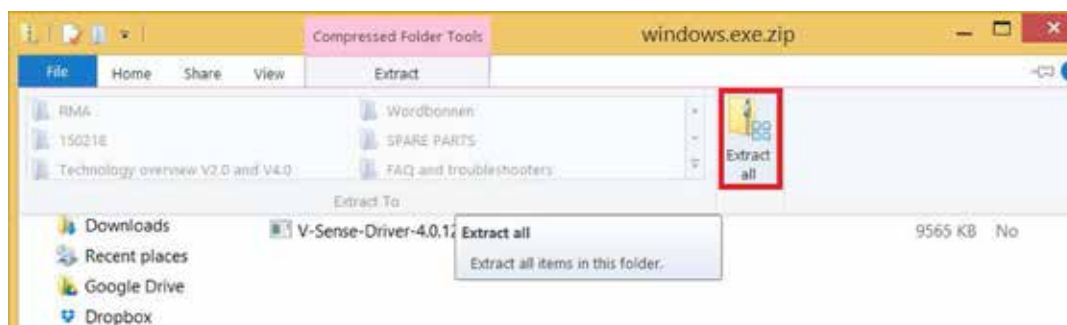

Now click on the file "V-Sense Driver – x.x.xx.xx.exe" (version number depends on the download date). If you cannot open the file, right click on the file and choose "run as administrator". Make sure you have installation rights.

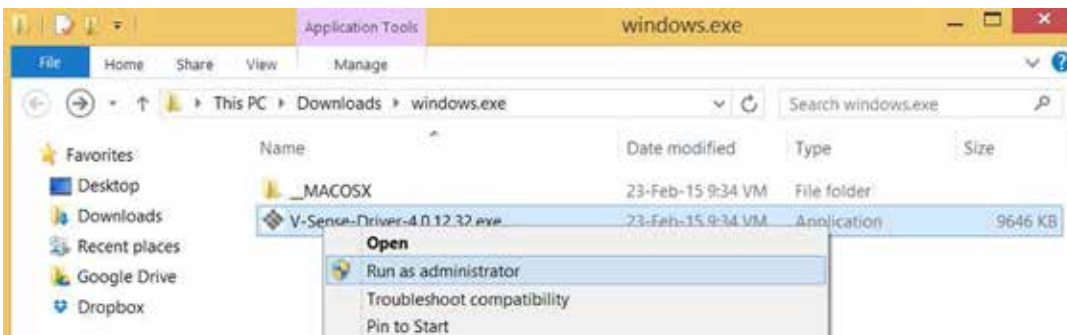

Run the installer and click 4 times “next” and finally “install”. If you can finish the installation, the drivers will ask for a reboot. Reboot your computer to finish the installation.



If the installation was successful, skip step 4

4 What to check when drivers can't be installed

The newest V-sense drivers can be installed even when no device is connected. If you install a driver and you get the message “please insert device and try again”, you are installing an older driver version. If you want to install an older driver (e.g. when the newest driver is not compatible anymore with your O.S.), make sure the computer is connected to the display when installing the drivers. If the display is not connected properly, you cannot finish the installation. The installer will ask you to insert the device and try again.

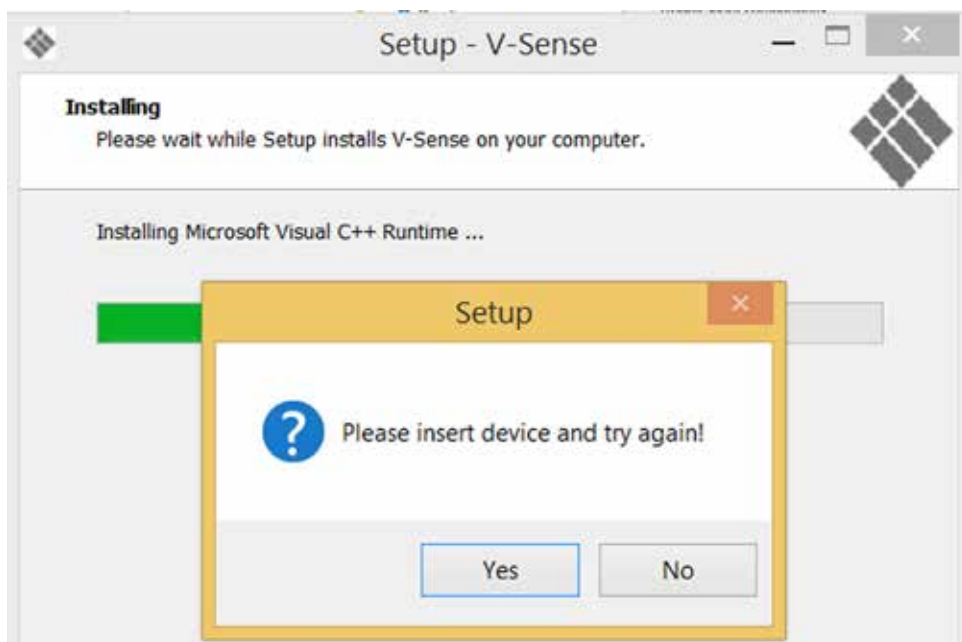

If the display is connected properly but you cannot finish the installation, make sure the USBport and cable are working & supplying sufficient power (see step 5). To check if the USB-port & cable are working, first try another USB-port. Then try another computer and/or try another short high quality USB-cable. Do not connect the i3TOUCH with your computer using multiple USB-cables (see step 6). Unless you concluded after testing that it is defect, we advise only to use the USB-cable delivered with the i3TOUCH. Prolonging the distance from i3TOUCH to PC using multiple USB-cables can result in a loss of power and signal strength (data signal).



5 Power supply

The i3TOUCH needs around 5 volts to be recognized & work properly. The touch sensor is powered via the USB-cable and the USB-port of your computer. In very seldom situations (!) a i3TOUCH Premium XX03 (XX stands for display size) can have touch that shows strange behavior such as random “ghost touch points” on locations where no finger or pen is located. The i3TOUCH XX04 Premium and the i3TOUCH Excellence series require a lower voltage and will therefore hardly be subject to power loss.

Strange behavior or a non-recognized touch sensor - when ports & connections were checked - are mostly the result of a USB-port not supplying sufficient power, cables that are prolonged or a single cable that is too long or not high quality. If you tried another cable and/or computer and the problem is only encountered with one computer, use a powered USB-hub (a USB-hub with its separate power supply providing a power boost to all USB-ports)



When you need to prolong the cable length to the i3TOUCH, use active USB extender cables. See step 6.

6 USB-cabling of the i3TOUCH

Normally a computer and a i3TOUCH will communicate without any troubles if only the delivered USB-cable is used. In some seldom cases however other cabling is necessary because of insufficient power (see step 5) or because the PC is located away from the display. Check if your installation setting matches with the below image. The active USB extender cables (RED) are only used when cables need to be prolonged. The USB hub (GREEN) is only used when the i3TOUCH is not getting sufficient power. See step 5.



7 Connecting the display (VGA/HDMI/DVI/DP)

Connect your computer with your display. If necessary, duplicate the image. The keycombination to be used to extend your image depends on your computer brand. E.g. Dellcomputers: FN+F5



Choose “duplicate” to see the computer image on both PC display and i3TOUCH, or “projector only” to see the computer image only on the i3TOUCH.

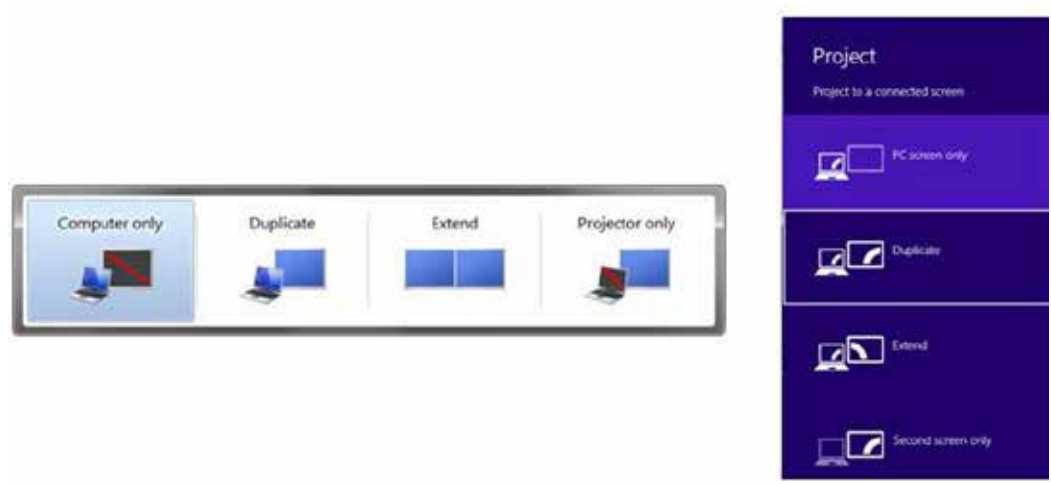

Make sure the image shown on both your computer screen as on the i3TOUCH is full screen.

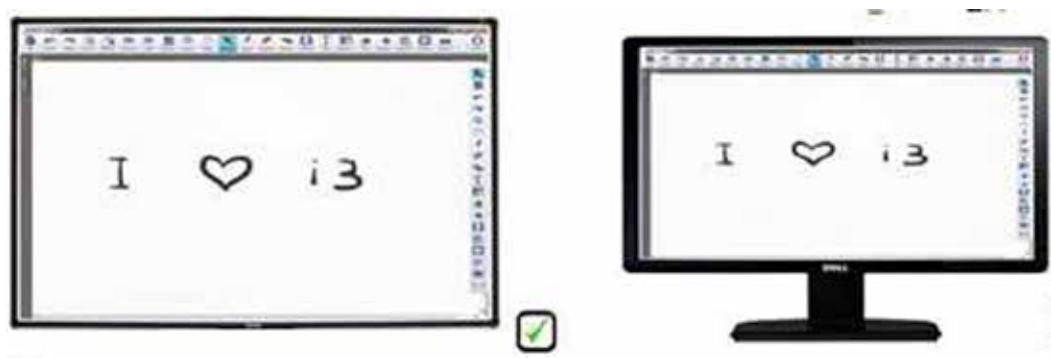

Prevent black borders left/right or top/bottom. This means there is a difference in resolution.

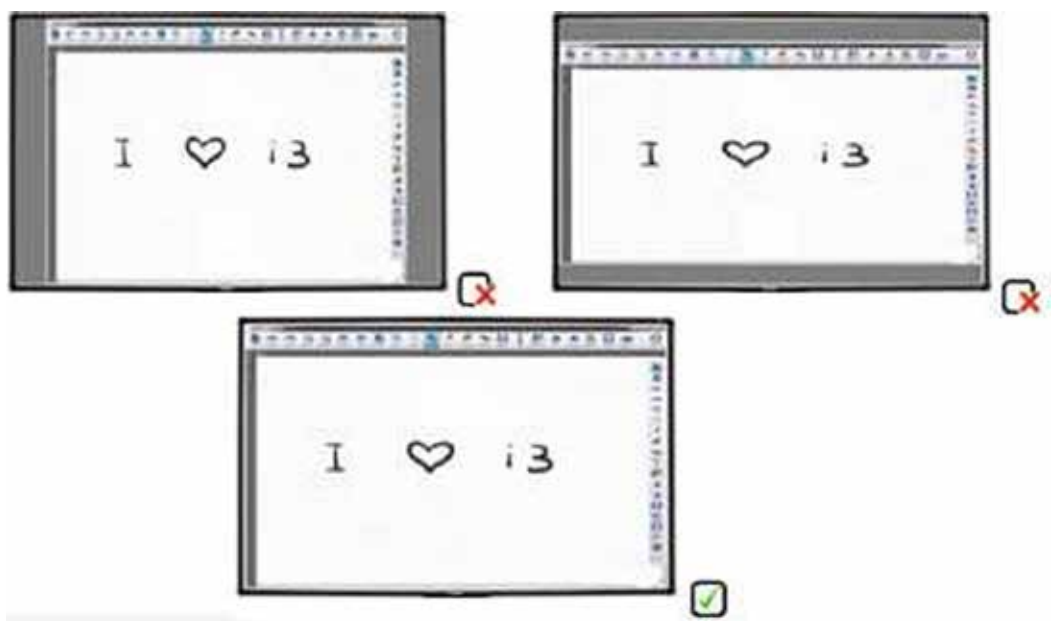

If the image on the computer display or the i3TOUCH is showing black borders, go to “control panel -> display -> screen resolution”. Choose the FHD (1920*1080) or 4K resolution (depending on i3TOUCH). Then choose duplicate.

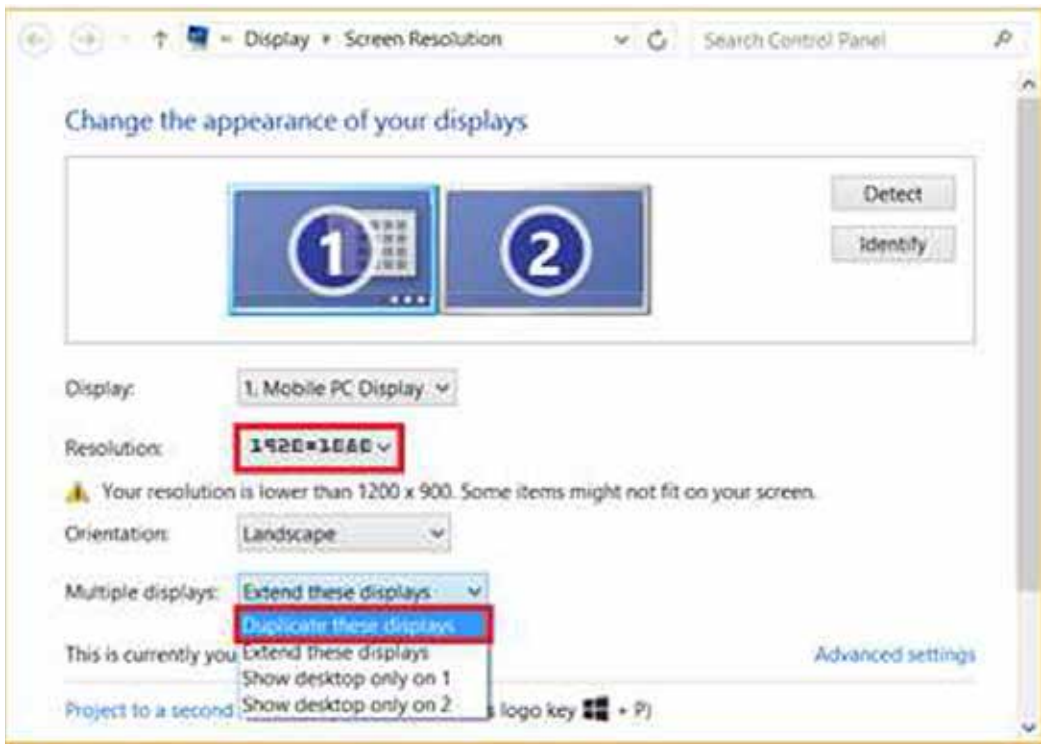

Now choose “advanced settings”. Choose the tab of your graphical card control panel. In this field you should see the options display, refresh rate, rotation and scaling.

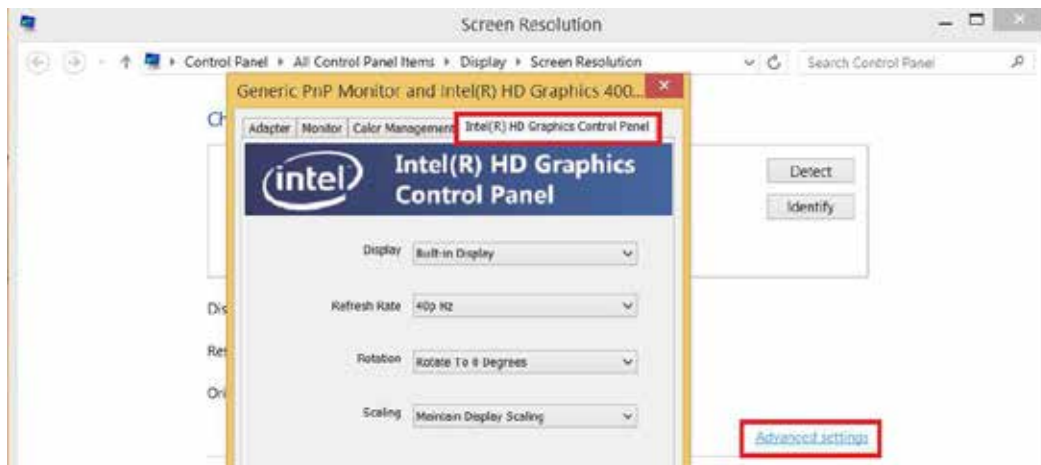

Click “display” and select the screen that needs to be scaled. Either your computer display (for laptops called “built-in display”) or the monitor. Click “scaling” and choose “scale full screen”. Then click “apply”. If necessary, have both scaled to full screen.

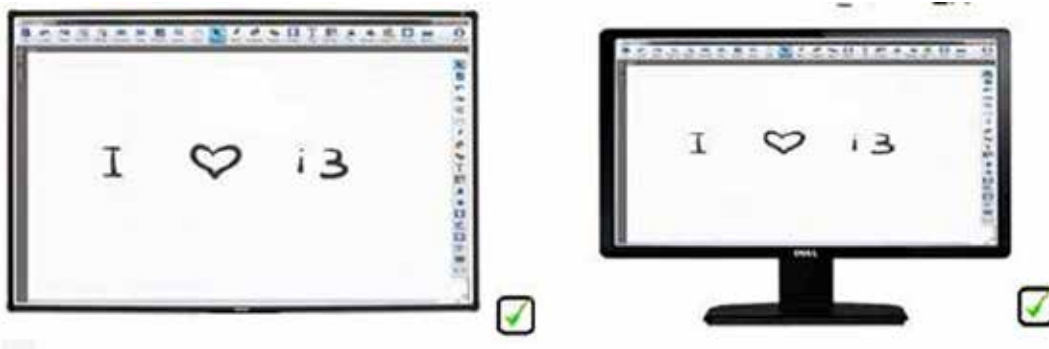

If you don't manage to have both screens scaled full screen, the graphical card of your computer or the drivers of this graphical card might need to be upgraded. As an alternative, choose “projector only” in your display settings and only use the 2nd display (i3TOUCH). If you prefer to use both computer display and i3TOUCH, move on to step 9 before heading to step 8.

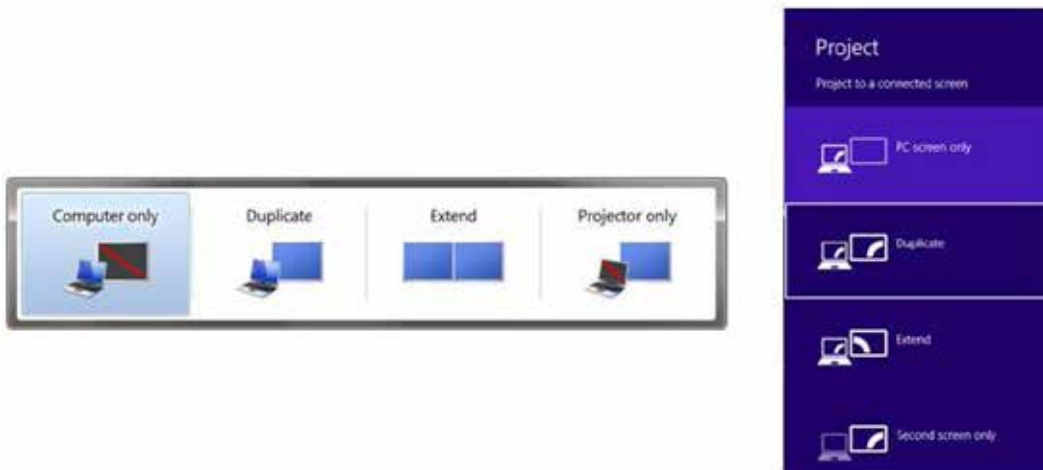

8 Calibrating the i3TOUCH

Calibrate your i3TOUCH. The best method to calibrate is using the V-sense drivers. Go to start -> all programs -> i3learning -> V-sense -> V-Sense Driver Configuration. If you have a windows 8.1 computer, search for the V-sense driver in the search field of the start screen.

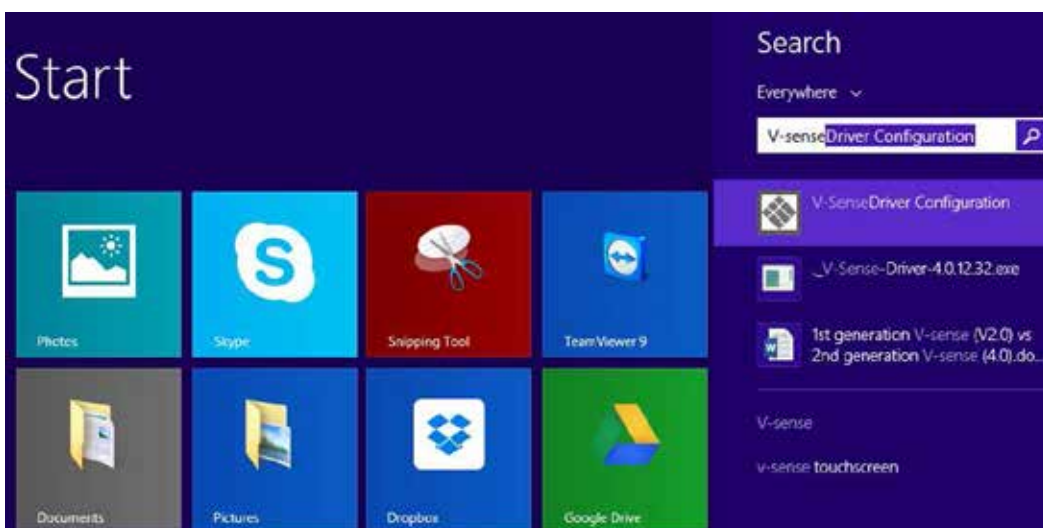

Choose calibration and press on the 9 red circles with your finger (or the i3TOUCH pen to increase accuracy) from the top left side to the bottom right side.



This concludes the calibration. Check if your i3TOUCH is calibrated well. If so, the display is ready to be used. Before using the display, please check step 11. If you cannot calibrate the display because of no touch, move to step 12.

If you calibrated the display but the calibration is not accurate, you can perform an extra calibration using the Windows calibration tool on top of the V-sense calibration. Go to "control panel" -> "tablet PC settings" (windows 7 / windows 8)

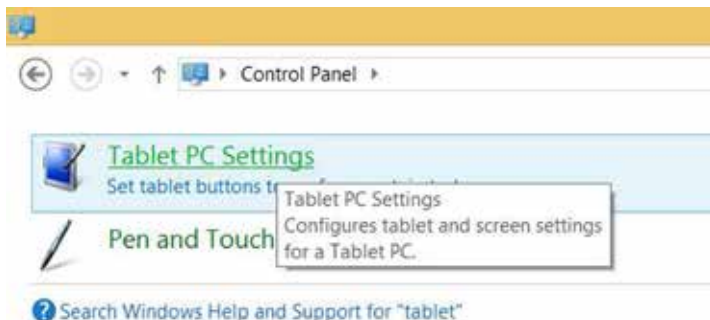

Now choose "calibrate and press with your finger on the black crosses

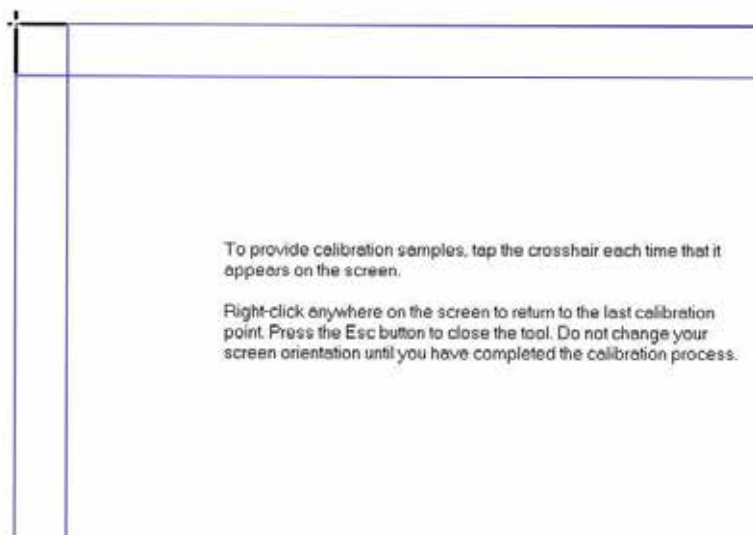
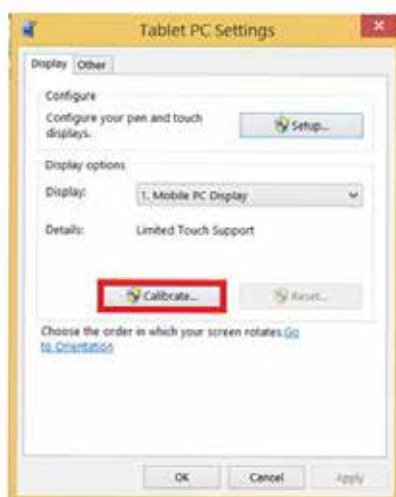

9 What to do if calibration is still inaccurate even after calibrating in V-sense & windows

If you calibrated using the V-sense drivers & windows calibration, if there are no black borders on the PC screen or the i3TOUCH image but still the calibration is not accurate, go to “screen resolution” (see step 7) and choose “extend” instead of duplicate and apply.

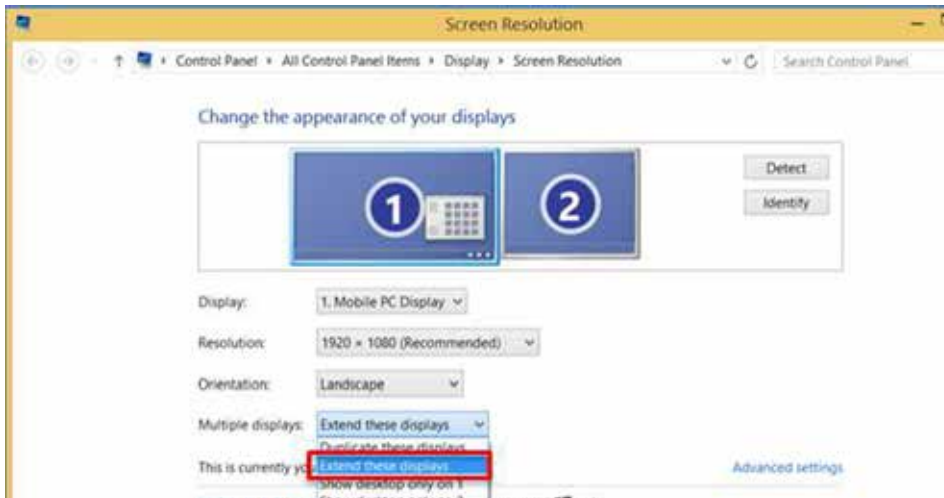

Now go to “control panel” -> “tablet PC settings” (windows 7 / windows 8)

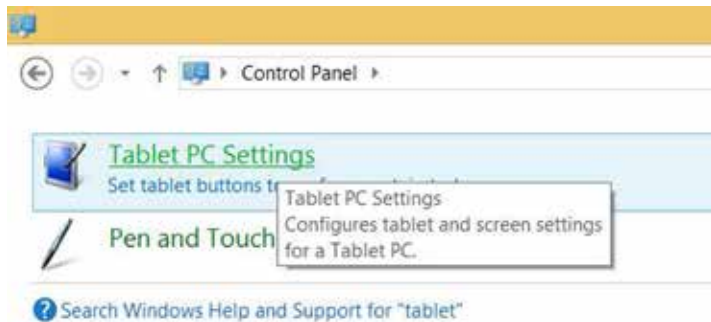

Follow the on-screen instructions. Tap on the i3TOUCH when the below instructions are shown on the display or press “enter” when you read the instructions on your computer screen only. With this step you identify the i3TOUCH as the touch screen to be used in windows. Finish with “escape”.



Touch the i3TOUCH and check if it recognizes touch, regardless to it's accuracy. Then check the accuracy of the touch. If not accurate, calibrate using the V-sense driver calibration. If still not accurate after calibration, go to screen resolution and choose “duplicate” again to duplicate your computer screen on the i3TOUCH.

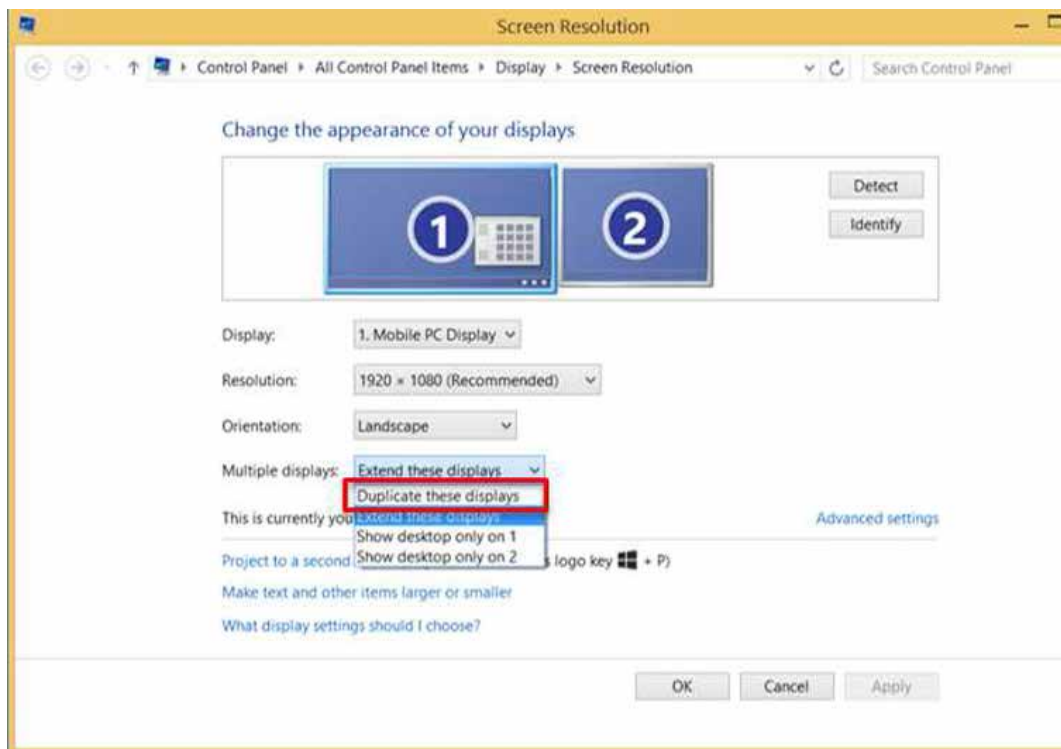

Calibrate again with the V-sense drivers and test the result. If the i3TOUCH is still not calibrated fully accurately, the problem might be related to your computer graphical card or its drivers that needs to be upgraded.

10 What to do if windows calibration does not start

Sometimes the Windows calibration cannot run because the i3TOUCH is already calibrated with the V-sense driver. Remove the V-sense drivers using the uninstaller (unins000.exe) in the folder "program files\i3 learning".

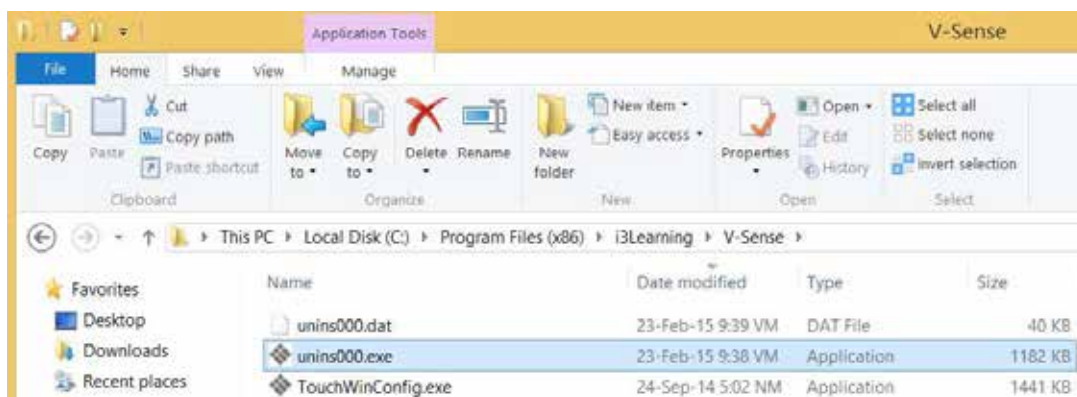

Now go to "control panel" -> "tablet PC settings" (windows 7 / windows 8)

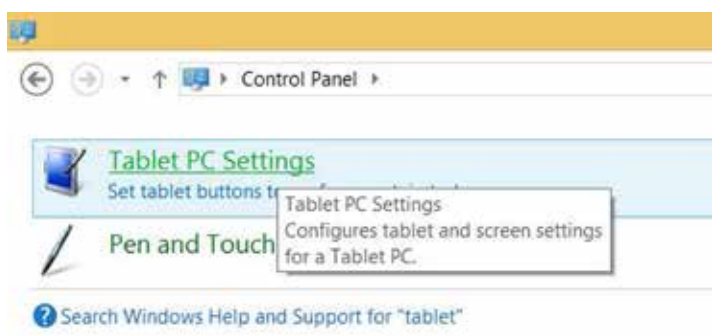

Choose "Setup"



Follow the on-screen instructions. Tap on the i3TOUCH when the below instructions are shown on the display or press "enter" when you read the instructions on your computer screen only. With this step you identify the i3TOUCH as the touch screen to be used in windows. Finish with "escape".



Now choose "calibrate" and press with your finger on the black crosses

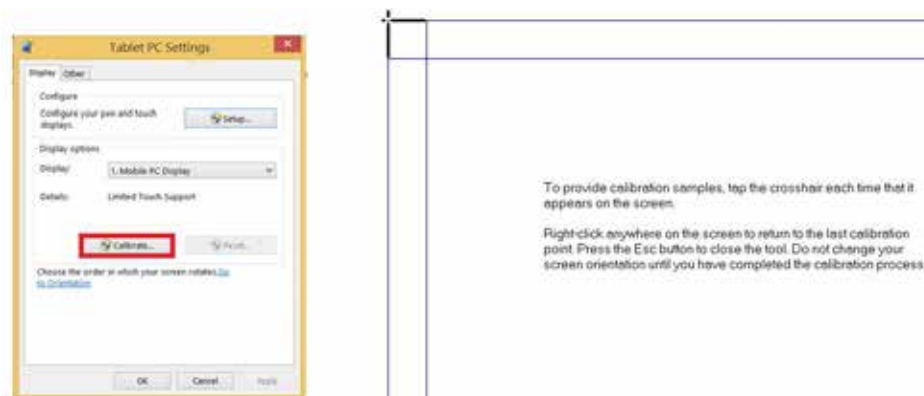

After having pressed on all the black crosses, the calibration is finished and the calibration should be fully accurate. If this is still not the case, contact your i3DEALER. Keep in mind the windows calibration tool only enables 7 touch points (windows 7 and higher).

Step. 11 Disabling “USB Selective suspend setting”

Some customers experience that touch is lost after 15 minutes. This is because the i3TOUCH touch sensor is fed by the power supplied from the USB-port of the computer and some computers have “USB selective suspend setting” enabled to save power. Go to Control Panel\All Control Panel Items\Power Options\Edit Plan Settings. Click “change advanced power settings”.

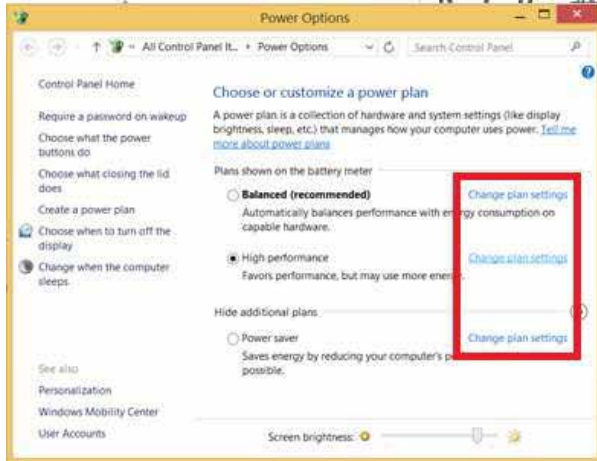

For each power plan used (!) click USB Settings -> USB selective suspend settings -> disable both “On Battery” and “Plugged In”

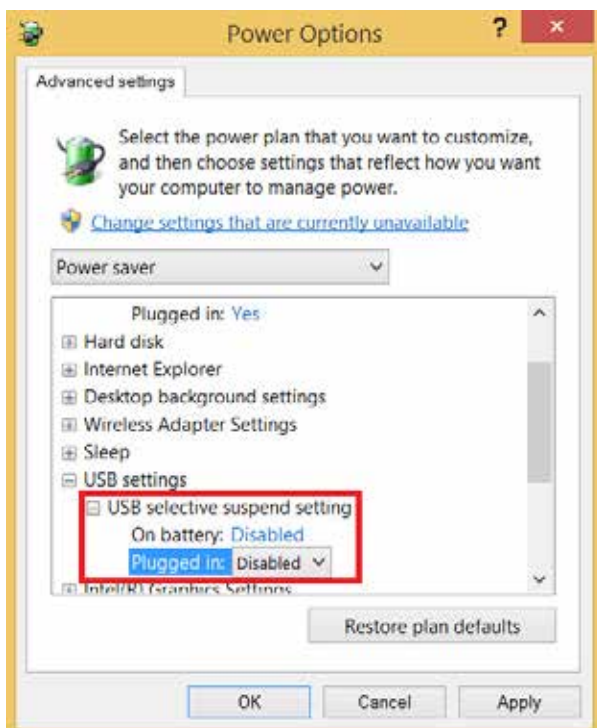

Step. 12 No touch after installing the driver

When the driver was installed but you have no touch, this may be due to:

a) The touch sensor being recognized earlier than the display screen at start-up

To check this, unplug the USB-cable and reboot your computer. After reboot, when an image is shown on the display, wait 10 extra seconds and plug the USB-cable. Check if there is touch. If touch is recognized but the problem is persistent, contact your i3 support contact person. You might need a driver update. Check if you downloaded the latest drivers on the website and if so, contact i3 support.

b) A touch driver conflict

Check if you have touch when opening the V-sense driver and selecting “mouse” mode in settings and then “apply”. If you have touch, you might need a driver update. Check if you downloaded the latest drivers on the website and if so, contact i3 support

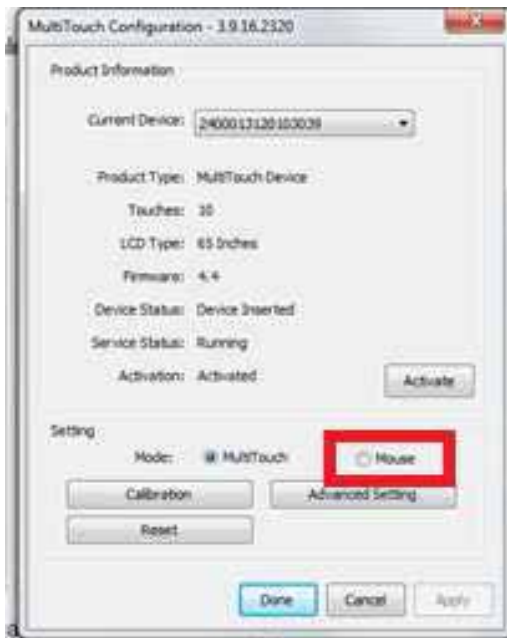

if you don't have touch using “mouse” mode, check your system settings (Control Panel\All Control Panel Items\System). If the drivers are working the pen & touch should indicate 32 touch points.

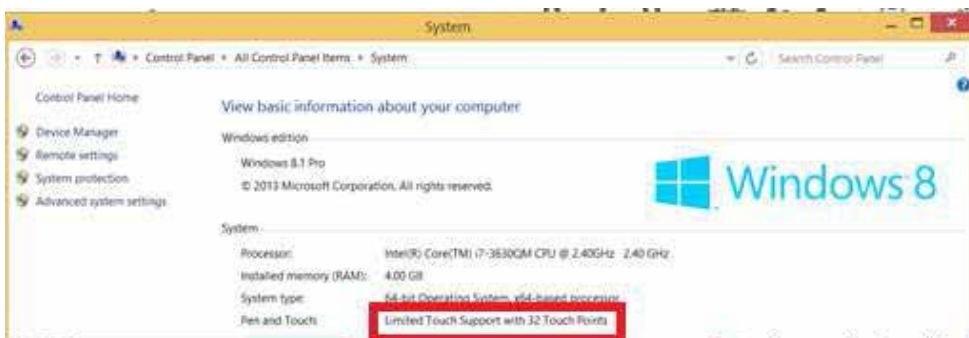

If you don't see 32 touch points, the driver is not running correctly. You might need a driver update. Check if you downloaded the latest drivers on the website and if so, contact i3 support.

c) The “turn on fast start-up function”

Some computers have a “turn on fast start-up” function to quickly boot. If that function is enabled, sometimes the touch sensor is not recognized at start-up or the touch sensor is recognized before the projector/display, which causes a conflict.

Go to Control Panel\All Control Panel Items\Power Options. Choose “require a password on wakeup”

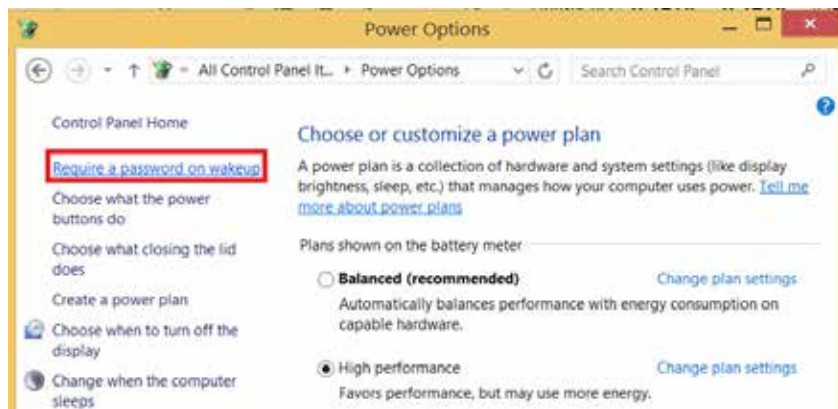

Choose “change settings that are currently unavailable”

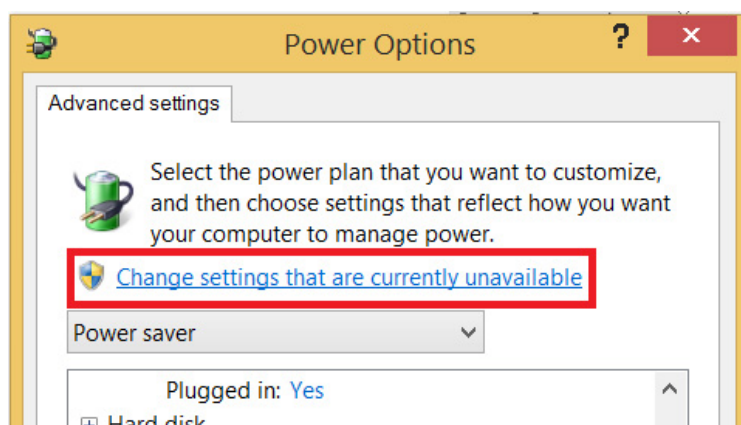

Turn off “fast startup”

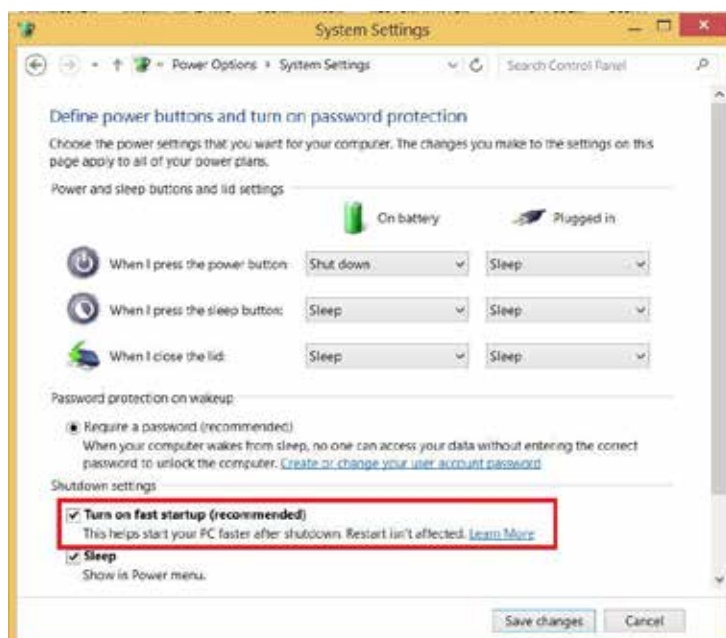

Step. 13 What to do if you can't duplicate your screen

If you can't duplicate your screen, contact your internal ICT support. Some computers have onboard graphics of the motherboard controlling the display of the laptop (e.g. intel HD Graphics 4000) but also have an extra (stronger) graphics card (e.g. Nvidia NVS 5200M) to control (F)HD projectors or displays connected to the computer.

It can happen the settings you change in "display -> screen resolution" only change the onboard graphics settings while the device connected to your HDMI-port is controlled by the graphics card and it is difficult to duplicate. When duplicating you see this



In that case you need to enter the control panel of your graphics card and choose duplicate or clone with laptop display. Below is an example of Nvidia:

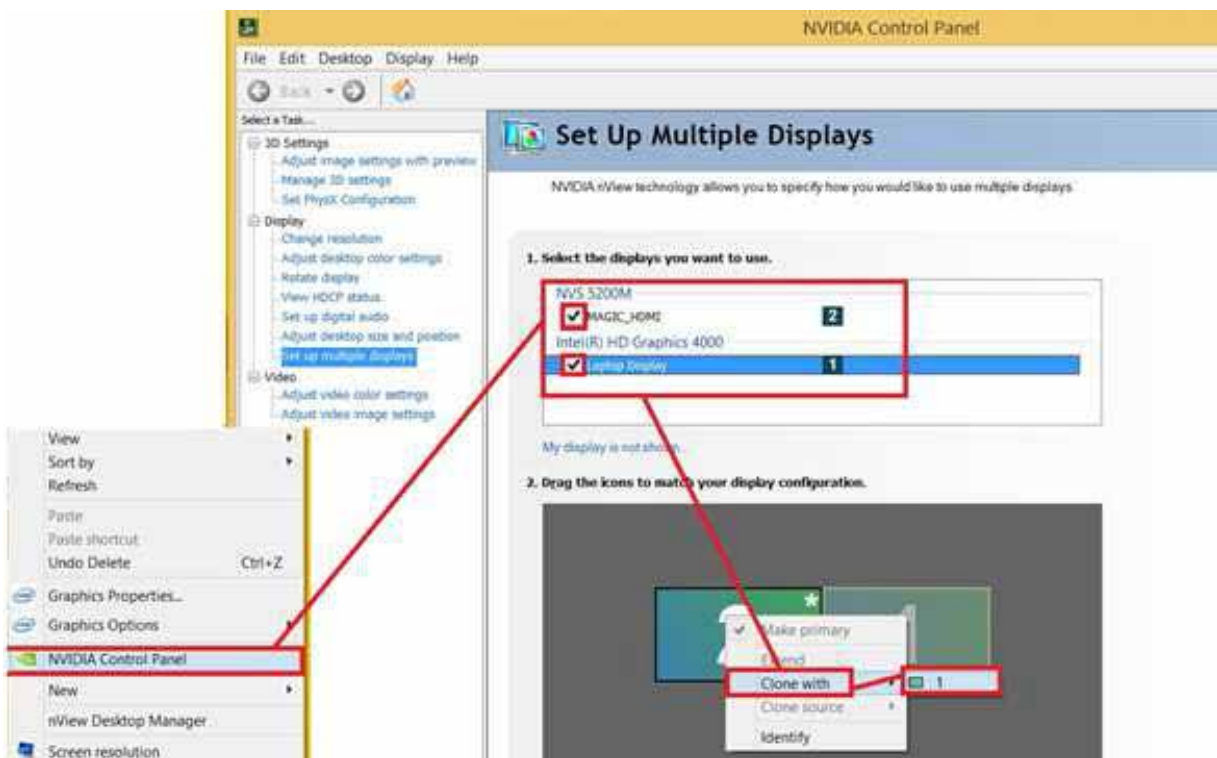

AUTHORISED DISTRIBUTOR



WWW.I3-TECHNOLOGIES.COM
INFO@I3-TECHNOLOGIES.COM